



Cool Clip Fittings

Air Conditioning
Fittings Catalog

Table of Contents

Galaxy Air Conditioning Hose 3

GALAXY 4826 Hose	3
GALAXY 4867 Hose	3
GALAXY 4890 Hose	3

Fitting Nomenclature 4

AC Crimp Fittings 5

Compressor O-Ring Tube, Female, 45 Elbow	5
Compressor O-Ring Tube, Female, 90 Elbow	5
Compressor O-Ring Tube, Female, 90 Block Elbow	5
O-Ring Insert, Male, 45 Elbow	6
Compressor O-Ring Tube, Female, R134a Valve, 90 Block Elbow	6
Flareless Tube, Male	7
Flareless Tube, Male, 90 Block Elbow	7
Flareless Tube, Male, Metric	8
O-Ring Insert, Male	8
O-Ring Insert, Male, 90 Elbow	8
64O-Ring Insert, Male, Bulkhead70	9
O-Ring Insert, Male, Bulkhead, 90 Elbow	9
O-Ring Insert, Male, R134a Valve	9
O-Ring Insert, Male, R134a Valve, 90 Elbow	10
O-Ring Tube, Female, Swivel	10
O-Ring Tube, Female, Swivel, 45 Elbow	11
O-Ring Tube, Female, Swivel, 90 Elbow	11
O-Ring Tube, Female, Swivel, 90 Block Elbow	12
O-Ring Tube, Female, Swivel, 180 Elbow	12
O-Ring Tube, Female, Swivel, Metric	12
O-Ring Tube, Female, Swivel, Metric, 45 Elbow	13
O-Ring Tube, Female, Swivel, Metric, 90 Elbow	13
O-Ring Tube, Female, Swivel, R12 Valve	14
O-Ring Tube, Female, Swivel, R12 Valve, 90 Elbow	14
O-Ring Tube, Female, Swivel, R134a Valve	14
O-Ring Tube, Female, Swivel, R134a Valve, 45 Elbow	15
O-Ring Tube, Female, Swivel, R134a Valve, 90 Elbow	15
O-Ring Tube, Male, Swivel	16
O-Ring Tube, Male, Swivel, 45 Elbow	16
O-Ring Tube, Male, Swivel, 90 Elbow	17
O-Ring Tube, Male, Swivel, Long Pilot	17
O-Ring Tube, Male, Swivel, R134a Valve	18
O-Ring Tube, Male, Swivel, R134a Valve, 90 Elbow	18
SAE 45 Flare, Female, Swivel	18
SAE 45 Flare, Female, Swivel, 45 Elbow	19
SAE 45 Flare, Female, Swivel, 90 Elbow	19
SAE 45 Flare, Male	20
SAE 45 Flare, Male, 45 Elbow	20
SAE 45 Flare, Male, 90 Elbow	20

Cool Clip Fittings 21

Compressor Pad Block, R12 Valve/Switch, 90 Block Elbow	21
Compressor Pad Block, R12 Valve/Switch Reserved, 90 Elbow	21
Compressor O-Ring Tube, Female, 45 Elbow	21
Compressor O-Ring Tube, Female, 90 Elbow	22
Compressor O-Ring Tube, Female, 90 Block Elbow	22
Compressor O-Ring Tube, Female, R134a Valve, 90 Block Elbow	22
Flareless Tube, Braze-On	23
Flareless Tube, Male	23
Flareless Tube, Male	24
Flareless Tube, Male, Metric	24
Ford Spring Lock, Female	25
Ford Spring Lock, Female, 45 Elbow	25
Ford Spring Lock, Female, 90 Elbow	26
Ford Spring Lock, Male	26
Ford Spring Lock, Male, 45 Elbow	27
Ford Spring Lock, Male, 90 Elbow	27

Hose Mender	28
Hose Mender, 90 Elbow	28
Hose Mender, 180 Elbow	28
Hose Mender, R12 Valve	29
Hose Mender, with Sight Glass	29
Hose Mender, Tee	29
O-Ring Face Seal, Female, Swivel	30
O-Ring Face Seal, Female, Swivel, 90 Elbow	30
O-Ring Insert, Male	30
O-Ring Insert, Male, 45 Elbow	31
O-Ring Insert, Male, 90 Elbow	31
O-Ring Insert, Male, Bulkhead	31
O-Ring Insert, Male, Bulkhead, 90 Elbow	32
O-Ring Insert, Male, R134a Valve	32
O-Ring Insert, Male, R134a Valve, 90 Elbow	32
O-Ring Tube, Female, Swivel	33
O-Ring Tube, Female, Swivel, 45 Elbow	33
O-Ring Tube, Female, Swivel, 90 Elbow	34
O-Ring Tube, Female, Swivel, 90 Block Elbow	34
O-Ring Tube, Female, Swivel, 180 Elbow	35
O-Ring Tube, Female, Swivel, R12 Valve	35
O-Ring Tube, Female, Swivel, R12 Valve, 90 Elbow	35
O-Ring Tube, Female, Swivel, R134a Valve	36
O-Ring Tube, Female, Swivel, R134a Valve, 45 Elbow	36
O-Ring Tube, Female, Swivel, R134a Valve, 90 Elbow	37
O-Ring Tube, Male, Swivel	37
O-Ring Tube, Male, Swivel, 45 Elbow	38
O-Ring Tube, Male, Swivel, 90 Elbow	38
O-Ring Tube, Male, Swivel, Long Pilot	39
O-Ring Tube, Male, Swivel, R134a Valve	39
O-Ring Tube, Male, Swivel, R134a Valve, 90 Elbow	39
SAE 45 Flare, Female, Swivel	40
SAE 45 Flare, Female, Swivel, 45 Elbow	40
SAE 45 Flare, Female, Swivel, 90 Elbow	41
SAE 45 Flare, Male	41
SAE 45 Flare, Male, 45 Elbow	41
SAE 45 Flare, Male, 90 Elbow	42

AC Adapters 43

O-Ring Tube Compressor to O-Ring Insert, Male, 90 Elbow, R134a Valve	43
O-Ring Tube, Female to O-Ring Insert Male, R12 Valve	43
O-Ring Tube, Female to O-Ring Insert, Male, 90 Elbow, R12 Valve	43
O-Ring Tube, Female to O-Ring Insert, Male, R134a Valve	44
O-Ring Tube, Female to O-Ring Insert, Male, 90 Elbow, R134a Valve	44

AC Clip Fitting Accessories 45

Flareless Tube Nuts	45
Flareless Tube Sleeves	45
Flareless Tube Sleeves, Metric	45
Inline Orifice Tubes	46
O-Ring for Ford Spring Lock	46
O-Ring for Switch	46
O-Ring for Tube Fittings	47
Sealing Washers	47
Valve Adapters	47
Valve Caps	48
Valve Core	48
Metal Clip	48
Plastic Clip Holder	49
Clip Pliers	49
Hose Cutting Tool & Replacement Blades	49

Appendix 50

Notes 54

Galaxy® Air Conditioning Hose



GALAXY® 4826 Hose

SAE J2064 – Type C – Class II – Low Pressure

For use with Continental AC Crimp Fittings

Part #	Hose Size ID		Hose OD		Max. Working Pressure		Min. Bend Radius		Min. Burst Pressure		Weight
	in	mm	in	mm	psi	mpa	in	mm	psi	mpa	
G4826-06	5/16	7.9	0.75	19.1	500	3.4	0.6	16	2,000	13.8	0.20
G4826-08	13/32	10.3	0.91	23.0	500	3.4	1.0	25	2,000	13.8	0.28
G4826-10	1/2	12.7	1.00	25.4	500	3.4	1.3	32	2,000	13.8	0.33
G4826-12	5/8	15.9	1.13	28.6	350	2.4	2.0	50	1,750	12.1	0.38

Continuous Brand Layline Example: Galaxy by Continental, SAE J2064, Type C, Class II, 1/2 in. (132 mm), 4826, Size 10, Made in USA



GALAXY® 4867 Hose

SAE J2064 – Type C – Class I – Low Pressure

For use with Continental AC Crimp Fittings

Part #	Hose Size ID		Hose OD		Max. Working Pressure		Min. Bend Radius		Min. Burst Pressure		Weight
	in	mm	in	mm	psi	mpa	in	mm	psi	mpa	
G4867-14	3/4	19.1	1.13	28.6	350	2.4	6.3	160	1,750	12.1	0.26

Continuous Brand Layline Example: Continental Galaxy, A/C Hose, 3/4 in. (19 mm), 4867



GALAXY® 4890 Hose

SAE J2064 – Type C – Class I – Low Pressure

For use with Continental Cool Clip® Fittings

Part #	Hose Size ID		Hose OD		Max. Working Pressure		Min. Bend Radius		Min. Burst Pressure		Weight
	in	mm	in	mm	psi	mpa	in	mm	psi	mpa	
G4890-06	5/16	7.9	0.56	14.7	500	3.4	1.0	25	2,000	13.8	0.09
G4890-08	13/32	10.3	0.69	17.3	500	3.4	1.5	38	2,000	13.8	0.12
G4890-10	1/2	12.7	0.75	19.4	500	3.4	2.5	63	2,000	13.8	0.13
G4890-12	5/8	15.9	0.94	23.6	350	2.4	4.0	104	1,750	12.1	0.20

Continuous Brand Layline Example: Galaxy, SLE 4890, A/C Hose, 13/32 in. (10 mm), Continental R134a

Fitting Nomenclature

Fitting Style	Family	Fitting Family Description	Gender	Swivel	Valve (V)	Attribute
CB12VS	CB	Compressor Pad Block			R12	S=Single
CB12VSR	CB				R12	SR=Single Reversed
COTF	COT	Compressor O-Ring Tube	F	Yes		
COTF134V	COT		F	Yes	R134a	
FTBO	FT	Flareless Tube				BO=Brace On
FTM	FT		M			
FTMM	FT		M			M=Metric
FTN	FT					N=Nut
FTS	FT					S=Sleeve
FTSM	FT					S=Sleeve, M=Metric
FSLF	FSL	Ford Spring Lock	F			
FSLM	FSL		M			
HM	HM	Hose Mender				
HM12V	HM				R12	
HM134V	HM				R134a	
HMSG	HM					SG=Sight Glass
HMT	HM					T=Tee
ILOTORA	ILOT	Inline Orifice Tube				ORA=Orange
ILOTRED	ILOT					RED=Red
ILOTBLU	ILOT					BLU=Blue
ILOTBLK	ILOT					BLK=Black
ILOTWHI	ILOT					WHI=White
OFFX	OF	O-Ring Face Seal (SAE J1453 ORS/ORFS)	F	Yes		
OIM	OI	O-Ring Insert	M			
OIMB	OI		M			B=Bulkhead
OIM134V	OI		M		134a	
OTF	OT	O-Ring Tube	F	Yes		
OTF12V	OT		F	Yes	R12	
OTF134V	OT		F	Yes	R134a	
OTF134VHS	OT		F	Yes	R134a	HS=High Pressure Side
OTM	OT		M	Yes	R134a	
OTMLP	OT		M	Yes		LP=Long Pilot
OTM134V	OT		M	Yes	R134a	
SFFX	SF	SAE 45 J512 Flare	F	Yes		
SFM	SF		M			
SWA	SW	Sealing Washer				A=Accumulator
SWCN	SW					CN=Compressor Narrow
SWCW	SW					CW=Compressor Wide
VC12V	VC	Valve Cup			R12	
VC134VHS	VC				R134a	HS=High Pressure Side
VC134VLS	VC				R134a	LS=Low Pressure Side

Additional Prefix and Suffix
AC=Crimp Fitting
GC=Cool Clip® Fitting
45=45° Elbow
45B=45° Block Elbow
90=90° Elbow
90B=90° Block Elbow
180=180° Elbow
A=Aluminum

GC-OTF134V45

134V = R134a Valve

45 = 45° Elbow

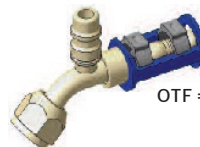

OTF = O-Ring Tube Female

AC Crimp Fittings

For use with Galaxy® G4826 (5/16"-5/8") and G4867 (3/4") Hose

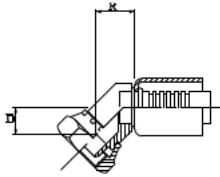

Compressor O-Ring Tube, Female, 45 Elbow

Descriptive Number	Product Number	Hose ID		Thread Size	Drop		Length		Valve	
		in	mm		in	mm	in	mm	in	mm
AC-COTF45-0810	50133-0810	13/32	10.30	1-14	1.10	28	2.01	51		
AC-COTF45-1010	50133-1010	1/2	12.70	1-14	1.26	32	1.38	35		
AC-COTF45-1210	50133-1210	5/8	15.90	1-14	0.67	17	1.26	32		

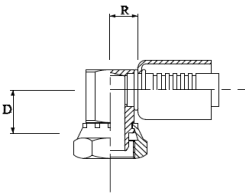

Compressor O-Ring Tube, Female, 90 Elbow

Descriptive Number	Product Number	Hose ID		Thread Size	Drop		Length		Valve	
		in	mm		in	mm	in	mm	in	mm
AC-COTF90-0810	50135-0810	13/32	10.30	1-14	1.93	49	1.77	45		
AC-COTF90-1010	50135-1010	1/2	12.70	1-14	2.20	56	1.77	45		
AC-COTF90-1210	50135-1210	5/8	15.90	1-14	2.72	69	2.36	60		

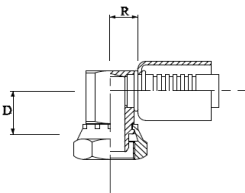

Compressor O-Ring Tube, Female, 90 Block Elbow

Descriptive Number	Product Number	Hose ID		Thread Size	Drop		Length		Valve	
		in	mm		in	mm	in	mm	in	mm
AC-COTF90B-0810	50137-0810	13/32	10.30	1-14	0.83	21	0.94	24		
AC-COTF90B-1010	50137-1010	1/2	12.70	1-14	0.83	21	0.94	24		
AC-COTF90B-1210	50137-1210	5/8	15.90	1-14	0.83	21	1.06	27		

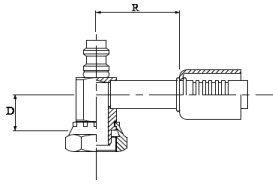

Compressor O-Ring Tube, Female, R134a Valve, 90 Block Elbow

Descriptive Number	Product Number	Hose ID		Thread Size	Drop		Length		Valve	
		in	mm		in	mm	in	mm	in	mm
AC-COTF134V90B-0810	50145-0810	13/32	10.30	1-14	0.83	21	0.94	24	0.63	16
AC-COTF134V90B-1010	50145-1010	1/2	12.70	1-14	0.83	21	0.94	24	0.51	13
AC-COTF134V90B-1210	50145-1210	5/8	15.90	1-14	0.83	21	1.06	27	0.51	13

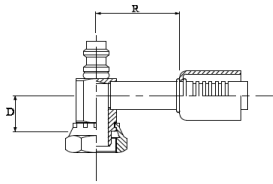

Flareless Tube, Male

Descriptive Number	Product Number	Hose ID		Thread Size	Drop		Length		Valve	
		in	mm		in	mm	in	mm	in	mm
AC-FTM-0606	50230-0606	5/16	7.90	5/8-18			1.46	37		
AC-FTM-0608	50230-0608	5/16	7.90	3/4-16			1.61	41		
AC-FTM-0608	50230-0806	13/32	10.30	5/8-18			1.61	41		
AC-FTM-0608	50230-0808	13/32	10.30	3/4-16			1.61	41		
AC-FTM-0608	50230-0810	13/32	10.30	7/8-14			2.13	54		
AC-FTM-0608	50230-1008	1/2	12.70	3/4-16			2.13	54		
AC-FTM-0608	50230-1010	1/2	12.70	7/8-14			2.13	54		
AC-FTM-0608	50230-1210	5/8	15.90	7/8-14			2.36	60		
AC-FTM-0608	50230-1212	5/8	15.90	1 1/16-14			2.36	60		

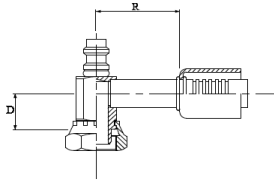

Flareless Tube, Male, 90 Block Elbow

Descriptive Number	Product Number	Hose ID		Thread Size	Drop		Length		Valve	
		in	mm		in	mm	in	mm	in	mm
AC-FTM90B-0606	50235-0606	5/16	7.90	5/8-18	1.5	38	1.06	27		
AC-FTM90B-0808	50235-0808	13/32	10.30	3/4-16	1.73	44	1.26	32		
AC-FTM90B-0810	50235-0810	13/32	10.30	7/8-14	2.01	51	1.50	38		
AC-FTM90B-1008	50235-1008	1/2	12.70	3/4-16	2.01	51	1.50	38		
AC-FTM90B-1010	50235-1010	1/2	12.70	7/8-14	2.01	51	1.50	38		
AC-FTM90B-1210	50235-1210	5/8	15.90	7/8-14	2.36	60	2.36	60		
AC-FTM90B-1212	50235-1212	5/8	15.90	1 1/16-14	2.36	60	2.36	60		

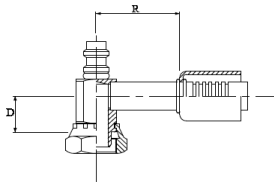

Flareless Tube, Male, Metric

Descriptive Number	Product Number	Hose ID		Thread Size	Drop		Length		Valve	
		in	mm		in	mm	in	mm	in	mm
AC-FTMM-0608	50240-0608	5/16	7.90	5/8-18			1.61	41		
AC-FTMM-0812	50240-0812	13/32	10.30	3/4-16			2.13	54		
AC-FTMM-1015	50240-1015	1/2	12.70	7/8-14			2.36	60		

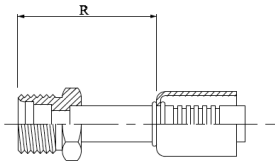

O-Ring Insert, Male

Descriptive Number	Product Number	Hose ID		Thread Size	Drop		Length		Valve	
		in	mm		in	mm	in	mm	in	mm
AC-OIM-0606	50500-0606	5/16	7.90	5/8-18			1.46	37		
AC-OIM-0808	50500-0808	13/32	10.30	3/4-16			1.61	41		
AC-OIM-1010	50500-1010	1/2	12.70	7/8-14			2.13	54		
AC-OIM-1210	50500-1210	5/8	15.90	7/8-14			1.69	43		
AC-OIM-1212	50500-1212	5/8	15.90	1 1/16-14			2.36	60		
AC-OIM-1412	50500-1412	3/4	19.05	1 1/16-14			2.36	60		

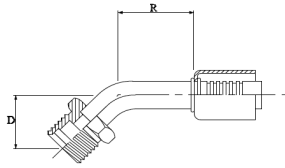

O-Ring Insert, Male, 45 Elbow

Descriptive Number	Product Number	Hose ID		Thread Size	Drop		Length		Valve	
		in	mm		in	mm	in	mm	in	mm
AC-OIM45-0606	50503-0606	5/16	7.90	5/8-18	0.75	19	0.83	21		
AC-OIM45-0808	50503-0808	13/32	10.30	3/4-16	0.98	25	0.94	24		
AC-OIM45-1010	50503-1010	1/2	12.70	7/8-14	1.26	32	1.26	32		
AC-OIM45-1212	50503-1212	5/8	15.90	1 1/16-14	1.38	35	1.50	38		
AC-OIM45-1412	50503-1412	3/4	19.05	1 1/16-14	1.38	35	1.50	38		

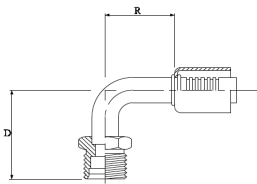

O-Ring Insert, Male, 90 Elbow

Descriptive Number	Product Number	Hose ID		Thread Size	Drop		Length		Valve	
		in	mm		in	mm	in	mm	in	mm
AC-OIM90-0606	50505-0606	5/16	7.90	5/8-18	1.50	38	1.06	27		
AC-OIM90-0808	50505-0808	13/32	10.30	3/4-16	1.73	44	1.26	32		
AC-OIM90-1010	50505-1010	1/2	12.70	7/8-14	2.01	51	1.50	38		
AC-OIM90-1210	50505-1210	5/8	15.90	7/8-14	2.17	55	1.97	50		
AC-OIM90-1212	50505-1212	5/8	15.90	1 1/16-14	2.52	64	2.36	60		
AC-OIM90-1412	50505-1412	3/4	19.05	1 1/16-14	2.52	64	2.36	60		

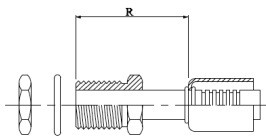

O-Ring Insert, Male, Bulkhead

Descriptive Number	Product Number	Hose ID		Thread Size	Drop		Length		Valve	
		in	mm		in	mm	in	mm	in	mm
AC-OIMB-0606	50515-0606	5/16	7.90	5/8-18			2.52	64		
AC-OIMB-0808	50515-0808	13/32	10.30	3/4-16			2.76	70		
AC-OIMB-1010	50515-1010	1/2	12.70	7/8-14			2.95	75		

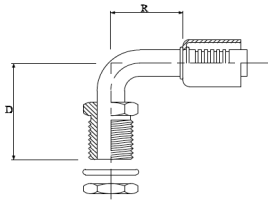

O-Ring Insert, Male, Bulkhead, 90 Elbow

Descriptive Number	Product Number	Hose ID		Thread Size	Drop		Length		Valve	
		in	mm		in	mm	in	mm	in	mm
AC-OIMB90-0606	50520-0606	5/16	7.90	5/8-18	2.13	54	1.61	41		
AC-OIMB90-0808	50520-0808	13/32	10.30	3/4-16	2.44	62	1.73	44		
AC-OIMB90-1010	50520-1010	5/8	15.90	7/8-14	2.52	64	2.01	51		

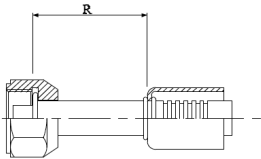

O-Ring Insert, Male, R134a Valve

Descriptive Number	Product Number	Hose ID		Thread Size	Drop		Length		Valve	
		in	mm		in	mm	in	mm	in	mm
AC-OIM134V-0606	50530-0606	5/16	7.90	5/8-18			2.44	62	0.63	16
AC-OIM134V-0808	50530-0808	13/32	10.30	3/4-16			2.56	65	0.63	16
AC-OIM134V-1010	50530-1010	1/2	12.70	7/8-14			1.77	45	0.51	13
AC-OIM134V-1212	50530-1212	5/8	15.90	1 1/16-14			2.95	75	0.51	13

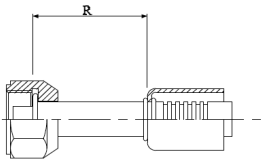

O-Ring Insert, Male, R134a Valve, 90 Elbow

Descriptive Number	Product Number	Hose ID		Thread Size	Drop		Length		Valve	
		in	mm		in	mm	in	mm	in	mm
AC-OIM134V90-0606	50535-0606	5/16	7.90	5/8-18	1.61	41	2.13	54	0.63	16
AC-OIM134V90-0808	50535-0808	13/32	10.30	3/4-16	1.89	48	2.13	54	0.63	16
AC-OIM134V90-1010	50535-1010	1/2	12.70	7/8-14	2.13	54	2.36	60	0.51	13

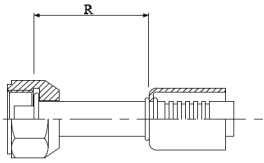

O-Ring Tube, Female, Swivel

Descriptive Number	Product Number	Hose ID		Thread Size	Drop		Length		Valve	
		in	mm		in	mm	in	mm	in	mm
AC-OTF-0605	50600-0605	5/16	7.90	9/16-18			1.30	33		
AC-OTF-0606	50600-0606	5/16	7.90	5/8-18			1.38	35		
AC-OTF-0608	50600-0608	5/16	7.90	3/4-16			1.50	38		
AC-OTF-0806	50600-0806	13/32	10.30	5/8-18			1.50	38		
AC-OTF-0808	50600-0808	13/32	10.30	3/4-16			1.50	38		
AC-OTF-1008	50600-1008	1/2	12.70	3/4-16			1.69	43		
AC-OTF-1010	50600-1010	1/2	12.70	7/8-14			1.69	43		
AC-OTF-1012	50600-1012	1/2	12.70	1 1/16-14			1.81	46		
AC-OTF-1210	50600-1210	5/8	15.90	7/8-14			1.81	46		
AC-OTF-1212	50600-1212	5/8	15.90	1 1/16-14			1.81	46		
AC-OTF-1412	50600-1412	3/4	19.05	1 1/16-14			1.81	46		

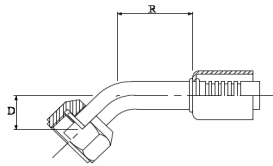

O-Ring Tube, Female, Swivel, 45 Elbow

Descriptive Number	Product Number	Hose ID		Thread Size	Drop		Length		Valve	
		in	mm		in	mm	in	mm	in	mm
AC-OTF45-0606	50603-0606	5/16	7.90	5/8-18	0.55	14	0.83	21		
AC-OTF45-0806	50603-0806	13/32	10.30	5/8-18	0.63	16	0.94	24		
AC-OTF45-0808	50603-0808	13/32	10.30	3/4-16	0.63	16	0.94	24		
AC-OTF45-1010	50603-1010	1/2	12.70	7/8-14	0.87	22	1.26	32		
AC-OTF45-1210	50603-1210	5/8	15.90	7/8-14	0.94	24	1.50	38		
AC-OTF45-1212	50603-1212	5/8	15.90	1 1/16-14	0.94	24	1.50	38		
AC-OTF45-1412	50603-1412	3/4	19.05	1 1/16-14	0.94	24	1.50	38		

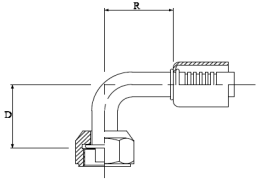

O-Ring Tube, Female, Swivel, 90 Elbow

Descriptive Number	Product Number	Hose ID		Thread Size	Drop		Length		Valve	
		in	mm		in	mm	in	mm	in	mm
AC-OTF90-0605	50605-0605	5/16	7.90	9/16-18	1.10	28	1.26	32		
AC-OTF90-0606	50605-0606	5/16	7.90	5/8-18	1.10	28	1.06	27		
AC-OTF90-0608	50605-0608	5/16	7.90	3/4-16	1.30	33	1.26	32		
AC-OTF90-0806	50605-0806	13/32	10.30	5/8-18	1.30	33	1.26	32		
AC-OTF90-0808	50605-0808	13/32	10.30	3/4-16	1.30	33	1.26	32		
AC-OTF90-1008	50605-1008	1/2	12.70	3/4-16	1.50	38	1.50	38		
AC-OTF90-1010	50605-1010	1/2	12.70	7/8-14	1.50	38	1.50	38		
AC-OTF90-1012	50605-1012	1/2	12.70	1 1/16-14	1.77	45	1.77	45		
AC-OTF90-1210	50605-1210	5/8	15.90	7/8-14	1.77	45	1.77	45		
AC-OTF90-1212	50605-1212	5/8	15.90	1 1/16-14	1.77	45	1.77	45		
AC-OTF90-1412	50605-1412	3/4	19.05	1 1/16-14	1.77	45	1.77	45		

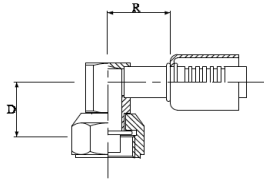

O-Ring Tube, Female, Swivel, 90 Block Elbow

Descriptive Number	Product Number	Hose ID		Thread Size	Drop		Length		Valve	
		in	mm		in	mm	in	mm	in	mm
AC-OTF90B-0808	50610-0808	13/32	10.30	3/4-16	0.75	19	0.94	24		
AC-OTF90B-1010	50610-1010	1/2	12.70	7/8-14	0.75	19	0.98	25		
AC-OTF90B-1212	50610-1212	5/8	15.90	7/8-14	0.75	19	0.98	25		

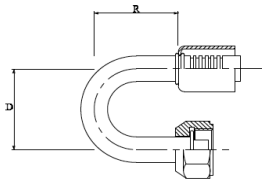

O-Ring Tube, Female, Swivel, 180 Elbow

Descriptive Number	Product Number	Hose ID		Thread Size	Drop		Length		Valve	
		in	mm		in	mm	in	mm	in	mm
AC-OTF180-0606	05615-0606	5/16	7.90	5/8-18	1.61	41	2.01	51		
AC-OTF180-0808	05615-0808	13/32	10.30	3/4-16	1.73	44	2.01	51		
AC-OTF180-1212	05615-1212	5/8	15.90	1 1/16-14	2.13	54	2.99	76		

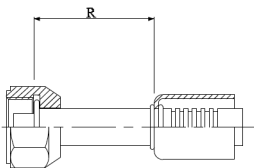

O-Ring Tube, Female, Swivel, Metric

Descriptive Number	Product Number	Hose ID		Thread Size	Drop		Length		Valve	
		in	mm		in	mm	in	mm	in	mm
AC-OTFM-0616	50630-0616	5/16	7.90	16x1.5			1.54	39		
AC-OTFM-0618	50630-0618	5/16	7.90	18x1.5			1.54	39		
AC-OTFM-0620	50630-0620	5/16	7.90	20x1.5			1.54	39		
AC-OTFM-0820	50630-0820	13/32	10.30	20x1.5			1.69	43		
AC-OTFM-1022	50630-1022	1/2	12.70	22x1.5			1.69	43		
AC-OTFM-1024	50630-1024	1/2	12.70	24x2.0			1.69	43		
AC-OTFM-1227	50630-1227	5/8	15.90	27x2.0			1.81	46		

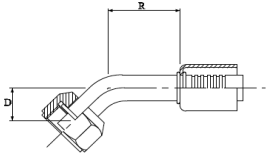

O-Ring Tube, Female, Swivel, Metric, 45 Elbow

Descriptive Number	Product Number	Hose ID		Thread Size	Drop		Length		Valve	
		in	mm		in	mm	in	mm	in	mm
AC-OTFM45-0614	50633-0614	5/16	7.90	14x1.5	0.55	14	0.98	25		
AC-OTFM45-0616	50633-0616	5/16	7.90	16x1.5	0.55	14	0.98	25		
AC-OTFM45-0618	50633-0618	5/16	7.90	18x1.5	0.55	14	0.98	25		
AC-OTFM45-0620	50633-0620	5/16	7.90	20x1.5	0.55	14	0.98	25		
AC-OTFM45-0820	50633-0820	13/32	10.30	20x1.5	0.63	16	0.98	25		
AC-OTFM45-1022	50633-1022	1/2	12.70	22x1.5	0.87	22	1.26	32		
AC-OTFM45-1024	50633-1024	1/2	12.70	24x1.5	0.87	22	1.26	32		
AC-OTFM45-1227	50633-1227	5/8	15.90	27x1.5	0.94	24	1.50	38		

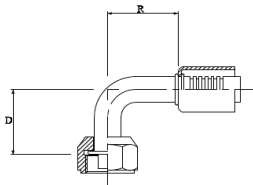

O-Ring Tube, Female, Swivel, Metric, 90 Elbow

Descriptive Number	Product Number	Hose ID		Thread Size	Drop		Length		Valve	
		in	mm		in	mm	in	mm	in	mm
AC-OTFM90-0616	50635-0616	5/16	7.90	16x1.5	1.10	28	1.06	27		
AC-OTFM90-0618	50635-0618	5/16	7.90	18x1.5	1.10	28	1.06	27		
AC-OTFM90-0620	50635-0620	5/16	7.90	20x1.5	1.10	28	1.06	27		
AC-OTFM90-0820	50635-0820	13/32	10.30	20x1.5	1.30	33	1.26	32		
AC-OTFM90-1022	50635-1022	1/2	12.70	22x1.5	1.50	38	1.50	38		
AC-OTFM90-1024	50635-1024	1/2	12.70	24x1.5	1.50	38	1.50	38		
AC-OTFM90-1227	50635-1227	5/8	15.90	27x1.5	1.77	45	1.77	45		

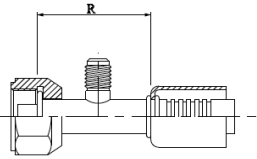

O-Ring Tube, Female, Swivel, R12 Valve

Descriptive Number	Product Number	Hose ID		Thread Size	Drop		Length		Valve	
		in	mm		in	mm	in	mm	in	mm
AC-OTF12V-0606	50650-0606	5/16	7.90	5/8-18			1.89	48	1/4	6.35
AC-OTF12V-0808	50650-0808	13/32	10.30	3/4-16			1.89	48	1/4	6.35
AC-OTF12V-1010	50650-1010	1/2	12.70	7/8-14			2.13	54	1/4	6.35

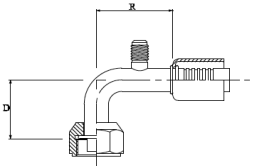

O-Ring Tube, Female, Swivel, R12 Valve, 90 Elbow

Descriptive Number	Product Number	Hose ID		Thread Size	Drop		Length		Valve	
		in	mm		in	mm	in	mm	in	mm
AC-OTF12V90-0606	50655-0606	5/16	7.90	5/8-18	1.10	28	2.13	54	1/4	6.35
AC-OTF12V90-0808	50655-0808	13/32	10.30	3/4-16	1.30	33	2.13	54	1/4	6.35
AC-OTF12V90-1010	50655-1010	1/2	12.70	7/8-14	1.50	38	2.36	60	1/4	6.35
AC-OTF12V90-1210	50655-1210	5/8	15.90	7/8-14	1.73	44	2.68	68	1/4	6.35

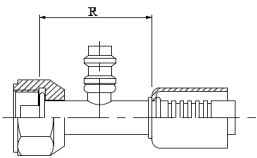

O-Ring Tube, Female, Swivel, R134a Valve

Descriptive Number	Product Number	Hose ID		Thread Size	Drop		Length		Valve	
		in	mm		in	mm	in	mm	in	mm
AC-OTF134V-0606	50660-0606	5/16	7.90	5/8-18			1.89	48	0.63	16
AC-OTF134V-0808	50660-0808	13/32	10.30	3/4-16			1.89	48	0.63	16
AC-OTF134V-1010	50660-1010	1/2	12.70	7/8-14			2.13	54	0.51	13
AC-OTF134V-1210	50660-1210	5/8	15.90	7/8-14			2.24	57	0.51	13
AC-OTF134V-1212	50660-1212	5/8	15.90	1 1/16-14			2.24	57	0.51	13
AC-OTF134V-1412	50660-1412	3/4	19.05	1 1/16-14			2.24	57	0.51	13
AC-OTF134VHS-1010	50675-1010	1/2	12.70	7/8-14			2.13	54	0.63	16

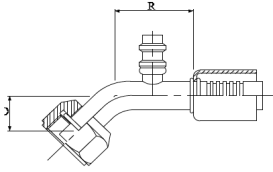

O-Ring Tube, Female, Swivel, R134a Valve, 45 Elbow

Descriptive Number	Product Number	Hose ID		Thread Size	Drop		Length		Valve	
		in	mm		in	mm	in	mm	in	mm
AC-OTF134V45-0606	50663-0606	5/16	7.90	5/8-18	0.55	14	1.61	41	0.63	16
AC-OTF134V45-0808	50663-0808	13/32	10.30	3/4-16	0.63	16	1.61	41	0.63	16
AC-OTF134V45-1010	50663-1010	1/2	12.70	7/8-14	0.87	22	1.73	44	0.51	13
AC-OTF134V45-1210	50663-1210	5/8	15.90	7/8-14	0.94	24	1.89	48	0.51	13
AC-OTF134V45-1212	50663-1212	5/8	15.90	1 1/16-14	0.94	24	1.89	48	0.51	13
AC-OTF134V45-1412	50663-1412	3/4	19.05	1 1/16-14	0.94	24	1.89	48	0.51	13

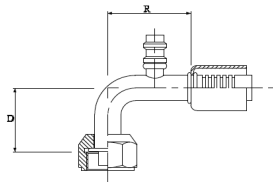

O-Ring Tube, Female, Swivel, R134a Valve, 90 Elbow

Descriptive Number	Product Number	Hose ID		Thread Size	Drop		Length		Valve	
		in	mm		in	mm	in	mm	in	mm
AC-OTF134V90-0606	50665-0606	5/16	7.90	5/8-18	1.10	28	2.13	54	0.63	16
AC-OTF134V90-0806	50665-0806	13/32	10.30	5/8-18	1.30	33	2.13	54	0.63	16
AC-OTF134V90-0808	50665-0808	13/32	10.30	3/4-16	1.30	33	2.13	54	0.63	16
AC-OTF134V90-1010	50665-1010	1/2	12.70	7/8-14	1.50	38	2.36	60	0.51	13
AC-OTF134V90-1210	50665-1210	5/8	15.90	7/8-14	1.73	44	2.68	68	0.51	13
AC-OTF134V90-1212	50665-1212	5/8	15.90	1 1/16-14	1.73	44	2.68	68	0.51	13
AC-OTF134V90-1412	50665-1412	3/4	19.05	1 1/16-14	1.73	44	2.68	68	0.51	13

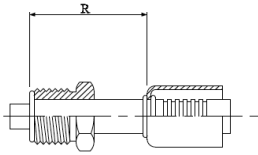

O-Ring Tube, Male, Swivel

Descriptive Number	Product Number	Hose ID		Thread Size	Drop		Length		Valve	
		in	mm		in	mm	in	mm	in	mm
AC-OTM-0606	50700-0606	5/16	7.90	5/8-18			1.69	43		
AC-OTM-0607	50700-0607	5/16	7.90	11/16-16			1.69	43		
AC-OTM-0608	50700-0608	5/16	7.90	3/4-18			1.77	45		
AC-OTM-0808	50700-0808	13/32	10.30	3/4-18			1.77	45		
AC-OTM-1010	50700-1010	1/2	12.70	7/8-18			1.89	48		
AC-OTM-1012	50700-1012	1/2	12.70	1 1/16-14			2.36	60		
AC-OTM-1210	50700-1210	5/8	15.90	7/8-18			2.36	60		
AC-OTM-1212	50700-1212	5/8	15.90	1 1/16-14			2.36	60		

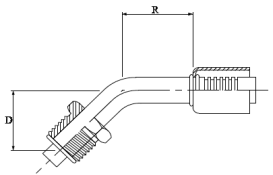

O-Ring Tube, Male, Swivel, 45 Elbow

Descriptive Number	Product Number	Hose ID		Thread Size	Drop		Length		Valve	
		in	mm		in	mm	in	mm	in	mm
AC-OTM45-0606	50703-0606	5/16	7.90	5/8-18	0.87	22	0.83	21		
AC-OTM45-0808	50703-0808	13/32	10.30	3/4-18	0.98	25	0.94	24		
AC-OTM45-1010	50703-1010	1/2	12.70	7/8-18	1.06	27	1.26	32		
AC-OTM45-1210	50703-1210	5/8	15.90	7/8-18	1.18	30	1.50	38		
AC-OTM45-1212	50703-1212	5/8	15.90	1 1/16-14	1.18	30	1.50	38		

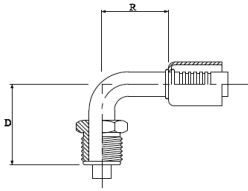

O-Ring Tube, Male, Swivel, 90 Elbow

Descriptive Number	Product Number	Hose ID		Thread Size	Drop		Length		Valve	
		in	mm		in	mm	in	mm	in	mm
AC-OTM90-0606	50705-0606	5/16	7.90	5/8-18	1.61	41	1.06	27		
AC-OTM90-0608	050705-0608	5/16	7.90	3/4-18	1.89	48	1.26	32		
AC-OTM90-0806	50705-0806	13/32	10.30	5/8-18	1.89	48	1.26	32		
AC-OTM90-0808	50705-0808	13/32	10.30	3/4-18	1.89	48	1.26	32		
AC-OTM90-1010	50705-1010	1/2	12.70	7/8-18	2.13	54	1.50	38		
AC-OTM90-1012	50705-1012	1/2	12.70	1 1/16-14	2.24	57	1.77	45		
AC-OTM90-1210	50705-1210	5/8	15.90	7/8-18	2.24	57	1.77	45		
AC-OTM90-1212	50705-1212	5/8	15.90	1 1/16-14	2.24	57	1.77	45		

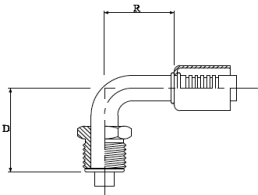

O-Ring Tube, Male, Swivel, Long Pilot

Descriptive Number	Product Number	Hose ID		Thread Size	Drop		Length		Valve	
		in	mm		in	mm	in	mm	in	mm
AC-OTMLP-0606	50720-0606	5/16	7.90	5/8-18	1.61	41	1.06	27		
AC-OTMLP-0808	50720-0808	13/32	10.30	3/4-18	1.89	48	1.26	32		
AC-OTMLP-1010	50720-1010	1/2	12.70	7/8-18	2.13	54	1.50	38		
AC-OTMLP-1210	50720-1210	5/8	15.90	7/8-18	2.24	57	1.77	45		

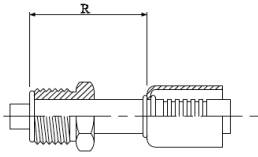

O-Ring Tube, Male, Swivel, R134a Valve

Descriptive Number	Product Number	Hose ID		Thread Size	Drop		Length		Valve	
		in	mm		in	mm	in	mm	in	mm
AC-OTM134V-0606	50730-0606	5/16	7.90	5/8-18			1.69	43	0.63	16
AC-OTM134V-0808	50730-0808	13/32	10.30	3/4-18			1.77	45	0.63	16
AC-OTM134V-1010	50730-1010	1/2	12.70	7/8-18			2.36	60	0.51	13
AC-OTM134V-1210	50730-1210	5/8	15.90	7/8-18			2.36	60	0.51	13
AC-OTM134V-1212	50730-1212	5/8	15.90	1 1/16-14			2.52	64	0.51	13

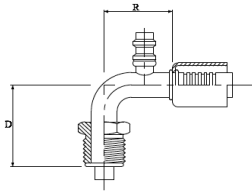

O-Ring Tube, Male, Swivel, R134a Valve, 90 Elbow

Descriptive Number	Product Number	Hose ID		Thread Size	Drop		Length		Valve	
		in	mm		in	mm	in	mm	in	mm
AC-OTM134V90-1010	50735-1010	1/2	12.70	7/8-18	2.13	54	2.36	60	0.51	13
AC-OTM134V90-1210	50735-1210	5/8	15.90	7/8-18	2.13	54	2.36	60	0.51	13

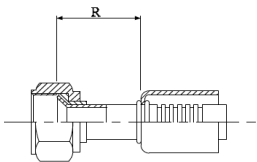

SAE 45 Flare, Female, Swivel

Descriptive Number	Product Number	Hose ID		Thread Size	Drop		Length		Valve	
		in	mm		in	mm	in	mm	in	mm
AC-SFFX-0606	50760-0606	5/16	7.90	5/8-18			1.38	35		
AC-SFFX-0608	50760-0608	5/16	7.90	3/4-16			1.18	30		
AC-SFFX-0806	50760-0806	13/32	10.30	5/8-18			1.18	30		
AC-SFFX-0808	50760-0808	13/32	10.30	3/4-16			1.18	30		
AC-SFFX-1008	50760-1008	1/2	12.70	3/4-16			1.50	38		
AC-SFFX-1010	50760-1010	1/2	12.70	7/8-14			1.50	38		
AC-SFFX-1210	50760-1210	5/8	15.90	7/8-14			1.73	44		
AC-SFFX-1212	50760-1212	5/8	15.90	1 1/16-14			1.73	44		

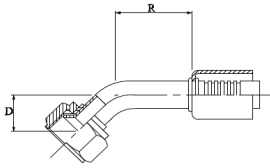

SAE 45 Flare, Female, Swivel, 45 Elbow

Descriptive Number	Product Number	Hose ID		Thread Size	Drop		Length		Valve	
		in	mm		in	mm	in	mm	in	mm
AC-SFFX45-0606	50763-0606	5/16	7.90	5/8-18	0.55	14	0.83	21		
AC-SFFX45-0808	50763-0608	5/16	7.90	3/4-18	0.63	16	0.94	24		
AC-SFFX45-0806	50763-0806	13/32	10.30	5/8-18	0.63	16	0.94	24		
AC-SFFX45-0808	50763-0808	13/32	10.30	3/4-18	0.63	16	0.94	24		
AC-SFFX45-1008	50763-1008	1/2	12.70	3/4-18	0.87	22	1.26	32		
AC-SFFX45-1010	50763-1010	1/2	12.70	7/8-18	0.87	22	1.26	32		
AC-SFFX45-1210	50763-1210	5/8	15.90	7/8-18	0.98	25	1.50	38		
AC-SFFX45-1212	50763-1212	5/8	15.90	1 1/16-14	0.98	25	1.50	38		

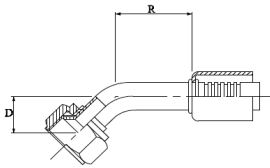

SAE 45 Flare, Female, Swivel, 90 Elbow

Descriptive Number	Product Number	Hose ID		Thread Size	Drop		Length		Valve	
		in	mm		in	mm	in	mm	in	mm
AC-SFFX90-0606	50765-0606	5/16	7.90	5/8-18	1.06	27	1.06	27		
AC-SFFX90-0608	50765-0608	5/16	7.90	3/4-18	1.26	32	1.26	32		
AC-SFFX90-0806	50765-0806	13/32	10.30	5/8-18	1.26	32	1.26	32		
AC-SFFX90-0808	50765-0808	13/32	10.30	3/4-18	1.26	32	1.26	32		
AC-SFFX90-1008	50765-1008	1/2	12.70	3/4-18	1.50	38	1.50	38		
AC-SFFX90-1010	50765-1010	1/2	12.70	7/8-18	1.50	38	1.50	38		
AC-SFFX90-1210	50765-1210	5/8	15.90	7/8-18	1.50	38	1.73	44		
AC-SFFX90-1212	50765-1212	5/8	15.90	1 1/16-14	1.50	38	1.73	44		

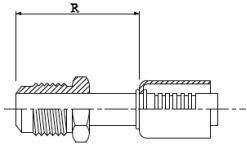

SAE 45 Flare, Male

Descriptive Number	Product Number	Hose ID		Thread Size	Drop		Length		Valve	
		in	mm		in	mm	in	mm	in	mm
AC-SFM-6060A	50780-0606A	5/16	7.90	5/8-18			1.89	48		
AC-SFM-0808A	50780-0808A	13/32	10.30	3/4-16			2.01	51		
AC-SFM-1010A	50780-1010A	1/2	12.70	7/8-14			2.32	59		
AC-SFM-1212A	50780-1212A	5/8	15.90	1 1/16-14			2.52	64		

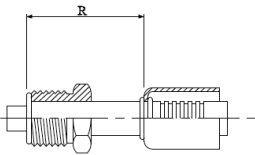

SAE 45 Flare, Male, 45 Elbow

Descriptive Number	Product Number	Hose ID		Thread Size	Drop		Length		Valve	
		in	mm		in	mm	in	mm	in	mm
AC-SFM45-0606A	50783-0606A	5/16	7.90	5/8-18	1.50	38	1.06	27		
AC-SFM45-0808A	50783-0808A	13/32	10.30	3/4-16	1.73	44	1.26	32		
AC-SFM45-1010A	50783-1010A	1/2	12.70	7/8-14	2.01	51	1.50	38		
AC-SFM45-1212A	50783-1212A	5/8	15.90	1 1/16-14	2.52	64	2.36	60		

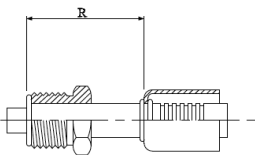

SAE 45 Flare, Male, 90 Elbow

Descriptive Number	Product Number	Hose ID		Thread Size	Drop		Length		Valve	
		in	mm		in	mm	in	mm	in	mm
AC-SFM90-0606A	50785-0606A	5/16	7.90	5/8-18	0.75	19	0.83	21		
AC-SFM90-0808A	50785-0808A	13/32	10.30	3/4-16	0.98	25	0.94	24		
AC-SFM90-1010A	50785-1010A	1/2	12.70	7/8-14	1.26	32	1.26	32		
AC-SFM90-1212A	50785-1212A	5/8	15.90	1 1/16-14	1.38	35	1.50	38		

Cool Clip Fittings

For use with Galaxy G4890 Hose

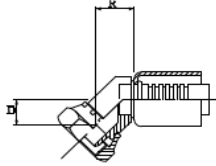

Compressor Pad Block, R12 Valve/Switch, 90 Block Elbow

Descriptive Number	Product Number	Hose ID		Thread Size	Drop		Length		Valve	
		in	mm		in	mm	in	mm	in	mm
GC-CB12VS90-0808	54110-0808	13/32	10.30							
GC-CB12VS90-1008	54110-1008	1/2	12.70							
GC-CB12VS90-1208	54110-1208	5/8	15.90							

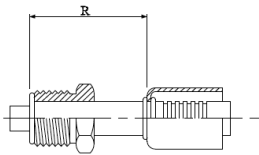

Compressor Pad Block, R12 Valve/Switch Reserved, 90 Elbow

Descriptive Number	Product Number	Hose ID		Thread Size	Drop		Length		Valve	
		in	mm		in	mm	in	mm	in	mm
GC-CB12VSR90-0808	54112-0808	13/32	10.30							
GC-CB12VSR90-1008	54112-1008	1/2	12.70							
GC-CB12VSR90-1208	54112-1208	5/8	15.90							



Compressor O-Ring Tube, Female, 45 Elbow

Descriptive Number	Product Number	Hose ID		Thread Size	Drop		Length		Valve	
		in	mm		in	mm	in	mm	in	mm
GC-COTF45-0810	54133-0810	13/32	10.30	1-14	0.39	10	1.65	42		
GC-COTF45-1010	54133-1010	1/2	12.70	1-14	0.39	10	1.65	42		
GC-COTF45-1210	54133-1210	5/8	15.90	1-14	0.39	10	1.65	42		

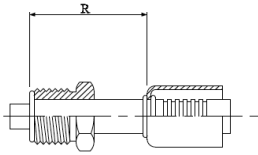

Compressor O-Ring Tube, Female, 90 Elbow

Similar to GC-COTF90B with bent tube, not block tube

Descriptive Number	Product Number	Hose ID		Thread Size	Drop		Length		Valve	
		in	mm		in	mm	in	mm	in	mm
GC-COTF90-0810	54135-0810	13/32	10.30	1-14	0.91	23	1.77	45		
GC-COTF90-1010	54135-1010	1/2	12.70	1-14	0.91	23	1.77	45		
GC-COTF90-1210	54135-1210	5/8	15.90	1-14	0.91	23	1.77	45		

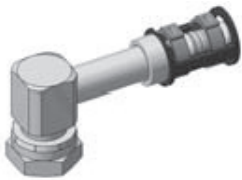

Compressor O-Ring Tube, Female, 90 Block Elbow

Descriptive Number	Product Number	Hose ID		Thread Size	Drop		Length		Valve	
		in	mm		in	mm	in	mm	in	mm
GC-COTF90B-0810	54137-0810	5/16	7.90	1-14	0.91	23	1.97	50		
GC-COTF90B-1010	54137-1010	13/32	10.30	1-14	0.91	23	1.97	50		
GC-COTF90B-1210	54137-1210	5/8	15.90	1-14	0.91	23	1.97	50		



Compressor O-Ring Tube, Female, R134a Valve, 90 Block Elbow

Descriptive Number	Product Number	Hose ID		Thread Size	Drop		Length		Valve	
		in	mm		in	mm	in	mm	in	mm
GC-COTF134V90B-0810	54145-0810	13/32	10.30	1-14	0.91	23	1.97	50	0.63	16
GC-COTF134V90B-1010	54145-1010	1/2	12.70	1-14	0.91	23	1.97	50	0.51	13
GC-COTF134V90B-1210	54145-1210	5/8	15.90	1-14	0.91	23	1.97	50	0.51	13



Flareless Tube, Braze-On

Descriptive Number	Product Number	Hose ID		Thread Size	Drop		Length		Valve	
		in	mm		in	mm	in	mm	in	mm
GC-FTBO-0606	54210-0606	5/16	7.90	3/8 Fitting			1.46	37		
GC-FTBO-0808	54210-0808	13/32	10.30	1/2 Fitting			1.46	37		
GC-FTBO-1010	54210-1010	1/2	12.70	5/8 Fitting			1.46	37		
GC-FTBO-1210	54210-1210	5/8	15.90	5/8 Fitting			1.46	37		
GC-FTBO-1212	54210-1212	5/8	15.90	3/4 Fitting			1.46	37		

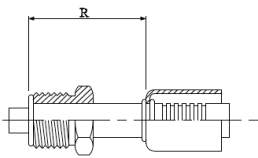

Flareless Tube, Male

Descriptive Number	Product Number	Hose ID		Thread Size	Drop		Length		Valve	
		in	mm		in	mm	in	mm	in	mm
GC-FTM-0606	54230-0606	5/16	7.90	5/8-18			2.44	62		
GC-FTM-0608	54230-0608	5/16	7.90	3/4-16			2.44	62		
GC-FTM-0806	54230-0806	13/32	10.30	5/8-18			2.44	62		
GC-FTM-0808	54230-0808	13/32	10.30	3/4-16			2.56	65		
GC-FTM-0810	54230-0810	13/32	10.30	7/8-14			2.56	65		
GC-FTM-1008	54230-1008	1/2	12.70	3/4-16			2.80	71		
GC-FTM-1010	54230-1010	1/2	12.70	7/8-14			2.80	71		
GC-FTM-1210	54230-1210	5/8	15.90	7/8-14			3.31	84		
GC-FTM-1212	54230-1212	5/8	15.90	1 1/16-14			3.31	84		

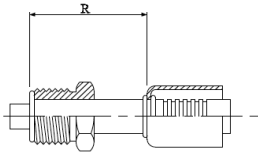

Flareless Tube, Male, 90 Block Elbow

Descriptive Number	Product Number	Hose ID		Thread Size	Drop		Length		Valve	
		in	mm		in	mm	in	mm	in	mm
GC-FTM90B-0606	54235-0606	5/16	7.90	5/8-18	1.22	31	1.06	27		
GC-FTM90B-0608	54235-0608	5/16	7.90	3/4-16	1.22	31	1.06	27		
GC-FTM90B-0806	54235-0806	13/32	10.30	5/8-18	1.22	31	1.06	27		
GC-FTM90B-0808	54235-0808	13/32	10.30	3/4-16	1.73	44	1.26	32		
GC-FTM90B-0810	54235-0810	13/32	10.30	7/8-14	1.73	44	1.26	32		
GC-FTM90B-1008	54235-1008	1/2	12.70	3/4-16	1.73	44	1.26	32		
GC-FTM90B-1010	54235-1010	1/2	12.70	7/8-14	2.09	53	1.57	40		
GC-FTM90B-1210	54235-1210	5/8	15.90	7/8-14	2.52	64	2.28	58		
GC-FTM90B-1212	54235-1212	5/8	15.90	1 1/16-14	2.52	64	2.28	58		

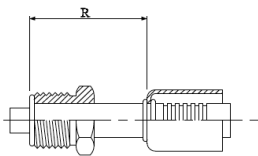

Flareless Tube, Male, Metric

Descriptive Number	Product Number	Hose ID		Thread Size	Drop		Length		Valve	
		in	mm		in	mm	in	mm	in	mm
GC-FTMM-0608	54240-0608	5/16	7.90	5/8-18			2.44	62		
GC-FTMM-0812	54240-0812	13/32	10.30	3/4-16			2.56	65		
GC-FTMM-1015	54240-1015	1/2	12.70	7/8-14			3.31	84		

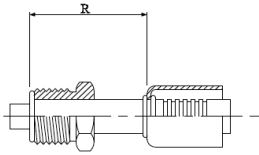

Ford Spring Lock, Female

Descriptive Number	Product Number	Hose ID		Thread Size	Drop		Length		Valve	
		in	mm		in	mm	in	mm	in	mm
GC-FSLF-0606A	54300-0606A	5/16	7.90	FSL-06			2.52	64		
GC-FSLF-0608A	54300-0608A	5/16	7.90	FSL-08			2.52	64		
GC-FSLF-0808A	54300-0808A	13/32	10.30	FSL-08			2.76	70		
GC-FSLF-1010A	54300-1010A	1/2	12.70	FSL-10			2.95	75		
GC-FSLF-1210A	54300-1210A	5/8	15.90	FSL-10			2.95	75		
GC-FSLF-1212A	54300-1212A	5/8	15.90	FSL-12			2.95	75		

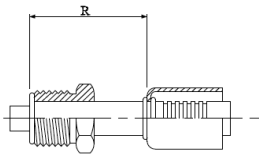

Ford Spring Lock, Female, 45 Elbow

Descriptive Number	Product Number	Hose ID		Thread Size	Drop		Length		Valve	
		in	mm		in	mm	in	mm	in	mm
GC-FSLF45-0606A	54303-0606A	5/16	7.90	FSL-06	1.30	33	1.50	38		
GC-FSLF45-0608A	54303-0608A	5/16	7.90	FSL-08	1.30	33	1.50	38		
GC-FSLF45-0808A	54303-0808A	13/32	10.30	FSL-08	1.30	33	0.94	24		
GC-FSLF45-1010A	54303-1010A	1/2	12.70	FSL-10	1.42	36	1.26	32		
GC-FSLF45-1210A	54303-1210A	5/8	15.90	FSL-10	1.42	36	1.26	32		
GC-FSLF45-1212A	54303-1212A	5/8	15.90	FSL-12	1.42	36	1.26	32		

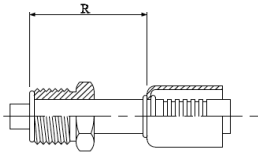

Ford Spring Lock, Female, 90 Elbow

Descriptive Number	Product Number	Hose ID		Thread Size	Drop		Length		Valve	
		in	mm		in	mm	in	mm	in	mm
GC-FSLF90-0606A	54305-0606A	5/16	7.90	FSL-06	2.13	54	1.61	41		
GC-FSLF90-0608A	54305-0608A	5/16	7.90	FSL-08	2.13	54	1.61	41		
GC-FSLF90-0808A	54305-0808A	13/32	10.30	FSL-08	2.44	62	1.73	44		
GC-FSLF90-1010A	54305-1010A	1/2	12.70	FSL-10	2.52	64	2.01	51		
GC-FSLF90-1210A	54305-1210A	5/8	15.90	FSL-10	2.52	64	2.01	51		
GC-FSLF90-1212A	54305-1212A	5/8	15.90	FSL-12	2.52	64	2.01	51		

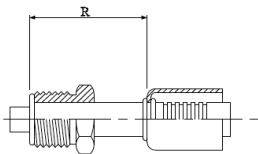

Ford Spring Lock, Male

Descriptive Number	Product Number	Hose ID		Thread Size	Drop		Length		Valve	
		in	mm		in	mm	in	mm	in	mm
GC-FSLM-0606A	54330-0606A	5/16	7.90	FSL-06			2.36	60		
GC-FSLM-0608A	54330-0608A	5/16	7.90	FSL-08			2.36	60		
GC-FSLM-0808A	54330-0808A	13/32	10.30	FSL-08			2.36	60		
GC-FSLM-1010A	54330-1010A	1/2	12.70	FSL-10			2.64	67		
GC-FSLM-1210A	54330-1210A	5/8	15.90	FSL-10			2.64	67		
GC-FSLM-1212A	54330-1212A	5/8	15.90	FSL-12			2.76	70		

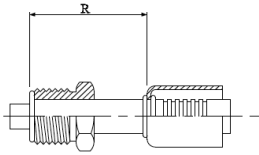

Ford Spring Lock, Male, 45 Elbow

Descriptive Number	Product Number	Hose ID		Thread Size	Drop		Length		Valve	
		in	mm		in	mm	in	mm	in	mm
GC-FSLM45-0606A	54333-0606A	5/16	7.90	FSL-06	1.30	33	1.50	38		
GC-FSLM45-0608A	54333-0608A	5/16	7.90	FSL-08	1.30	33	1.50	38		
GC-FSLM45-0808A	54333-0808A	13/32	10.30	FSL-08	1.26	32	0.94	24		
GC-FSLM45-1010A	54333-1010A	1/2	12.70	FSL-10	1.42	36	1.26	32		
GC-FSLM45-1210A	54333-1210A	5/8	15.90	FSL-10	1.42	36	1.26	32		
GC-FSLM45-1212A	54333-1212A	5/8	15.90	FSL-12	1.42	36	1.26	32		

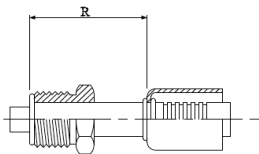

Ford Spring Lock, Male, 90 Elbow

Descriptive Number	Product Number	Hose ID		Thread Size	Drop		Length		Valve	
		in	mm		in	mm	in	mm	in	mm
GC-FSLM90-0606A	54335-0606A	5/16	7.90	FSL-06	2.13	54	1.61	41		
GC-FSLM90-0608A	54335-0608A	5/16	7.90	FSL-08	2.13	54	1.61	41		
GC-FSLM90-0808A	54335-0808A	13/32	10.30	FSL-08	2.44	62	1.73	44		
GC-FSLM90-1010A	54335-1010A	1/2	12.70	FSL-10	2.52	64	2.01	51		
GC-FSLM90-1210A	54335-1210A	5/8	15.90	FSL-10	2.52	64	2.01	51		
GC-FSLM90-1212A	54335-1212A	5/8	15.90	FSL-12	2.52	64	2.01	51		



Hose Mender

Descriptive Number	Product Number	Hose ID		Thread Size	Drop		Length		Valve	
		in	mm		in	mm	in	mm	in	mm
GC-HM-0606	54350-0606	5/16	7.90				1.46	37		
GC-HM-0608	54350-0608	5/16	7.90				1.46	37		
GC-HM-0808	54350-0808	13/32	10.30				1.46	37		
GC-HM-0810	54350-0810	13/32	10.30				1.46	37		
GC-HM-1010	54350-1010	1/2	12.70				1.46	37		
GC-HM-1210	54350-1210	5/8	15.90				1.46	37		
GC-HM-1212	54350-1212	5/8	15.90				1.46	37		



Hose Mender, 90 Elbow

Descriptive Number	Product Number	Hose ID		Thread Size	Drop		Length		Valve	
		in	mm		in	mm	in	mm	in	mm
GC-HM90-0606	54355-0606	5/16	7.90		0.59	15	0.59	15		
GC-HM90-0808	54355-0808	13/32	10.30		0.79	20	0.79	20		
GC-HM90-1010	54355-1010	1/2	12.70		0.98	25	0.98	25		
GC-HM90-1212	54355-1212	5/8	15.90		1.18	30	1.18	30		



Hose Mender, 180 Elbow

Descriptive Number	Product Number	Hose ID		Thread Size	Drop		Length		Valve	
		in	mm		in	mm	in	mm	in	mm
GC-HM180-0606	54360-0606	5/16	7.90		1.97	50	2.13	54		
GC-HM180-0808	54360-0808	13/32	10.30		2.36	60	2.13	54		
GC-HM180-1010	54360-1010	1/2	12.70		2.76	70	2.48	63		
GC-HM180-1212	54360-1212	5/8	15.90		3.15	80	3.15	80		



Hose Mender, R12 Valve

Picture same as GC-HM134V, with R12 Valve

Descriptive Number	Product Number	Hose ID		Thread Size		Drop		Length		Valve	
		in	mm			in	mm	in	mm	in	mm
GC-HM12V-0606	54365-0606	5/16	7.90					1.46	37	1/4	6.35
GC-HM12V-0808	54365-0808	13/32	10.30					1.46	37	1/4	6.35
GC-HM12V-1010	54365-1010	1/2	12.70					1.46	37	1/4	6.35
GC-HM12V-1212	54365-1212	5/8	15.90					1.46	37	1/4	6.35



Hose Mender, R134a Valve

Descriptive Number	Product Number	Hose ID		Thread Size		Drop		Length		Valve	
		in	mm			in	mm	in	mm	in	mm
GC-HM134V-0606	54370-0606	5/16	7.90					1.46	37	0.63	16
GC-HM134V-0808	54370-0808	13/32	10.30					1.46	37	0.63	16
GC-HM134V-1010	54370-1010	1/2	12.70					1.46	37	0.51	13
GC-HM134V-1212	54370-1212	5/8	15.90					1.46	37	0.51	13



Hose Mender, with Sight Glass

Picture same as GC-HM, with Sight Glass

Descriptive Number	Product Number	Hose ID		Thread Size		Drop		Length		Valve	
		in	mm			in	mm	in	mm	in	mm
GC-HMSG-0606	54375-0606	5/16	7.90					1.77	45		



Hose Mender, Tee

Descriptive Number	Product Number	Hose ID 1 & 2		Hose ID 3		Drop		Length		Valve	
		in	mm	in	mm	in	mm	in	mm	in	mm
GC-HMT-0606	54380-0606	5/16	7.90	5/16	7.90	0.87	22	1.73	44		
GC-HMT-0808	54380-0808	13/32	10.30	13/32	10.30	0.94	24	1.89	48		
GC-HMT-1010	54380-1010	1/2	12.70	1/2	12.70	1.38	35	2.01	51		
GC-HMT-1210	54380-1210	5/8	15.90	1/2	12.70	1.38	35	2.01	51		
GC-HMT-1212	54380-1212	5/8	15.90	5/8	15.90	1.38	35	2.24	57		



O-Ring Face Seal, Female, Swivel

Descriptive Number	Product Number	Hose ID		Thread Size	Drop		Length		Valve	
		in	mm		in	mm	in	mm	in	mm
GC-OFFX-0606	54430-0606	5/16	7.90	11/16-16			1.42	36		
GC-OFFX-0808	54430-0808	13/32	10.30	13/16-16			1.61	41		
GC-OFFX-1010	54430-1010	1/2	12.70	1-14			2.13	54		
GC-OFFX-1212	54430-1212	5/8	15.90	1 3/16-12			2.36	60		



O-Ring Face Seal, Female, Swivel, 90 Elbow

Descriptive Number	Product Number	Hose ID		Thread Size	Drop		Length		Valve	
		in	mm		in	mm	in	mm	in	mm
GC-OFFX90-0606	54435-0606	5/16	7.90	11/16-16	1.14	29	0.59	15		
GC-OFFX90-0808	54435-0808	13/32	10.30	13/16-16	1.34	34	0.79	20		
GC-OFFX90-1010	54435-1010	1/2	12.70	1-14	1.57	40	0.98	25		
GC-OFFX90-1212	54435-1212	5/8	15.90	1 3/16-12	1.81	46	1.18	30		



O-Ring Insert, Male

Descriptive Number	Product Number	Hose ID		Thread Size	Drop		Length		Valve	
		in	mm		in	mm	in	mm	in	mm
GC-OIM-0606	54500-0606	5/16	7.90	5/8-18			2.44	62		
GC-OIM-0808	54500-0808	13/32	10.30	3/4-16			2.56	65		
GC-OIM-1010	54500-1010	1/2	12.70	7/8-14			1.77	45		
GC-OIM-1210	54500-1210	5/8	15.90	7/8-14			1.77	45		
GC-OIM-1212	54500-1212	5/8	15.90	1 1/16-14			2.95	75		



O-Ring Insert, Male, 45 Elbow

Descriptive Number	Product Number	Hose ID		Thread Size	Drop		Length		Valve	
		in	mm		in	mm	in	mm	in	mm
GC-OIM45-0606	54503-0606	5/16	7.90	5/8-18	0.75	19	0.83	21		
GC-OIM45-0808	54503-0808	13/32	10.30	3/4-16	0.94	24	0.94	24		
GC-OIM45-1010	54503-1010	1/2	12.70	7/8-14	1.26	32	1.26	32		
GC-OIM45-1212	54503-1212	5/8	15.90	1 1/16-14	1.38	35	1.42	36		



O-Ring Insert, Male, 90 Elbow

Descriptive Number	Product Number	Hose ID		Thread Size	Drop		Length		Valve	
		in	mm		in	mm	in	mm	in	mm
GC-OIM90-0606	54505-0606	5/16	7.90	5/8-18	1.38	35	1.77	45		
GC-OIM90-0808	54505-0808	13/32	10.30	3/4-16	1.73	44	1.26	32		
GC-OIM90-1010	54505-1010	1/2	12.70	7/8-14	2.17	55	1.97	50		
GC-OIM90-1210	54505-1210	5/8	15.90	7/8-14	2.17	55	1.97	50		
GC-OIM90-1212	54505-1212	5/8	15.90	1 1/16-14	2.76	70	1.97	50		

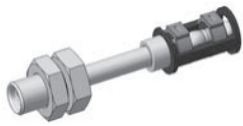

O-Ring Insert, Male, Bulkhead

Descriptive Number	Product Number	Hose ID		Thread Size	Drop		Length		Valve	
		in	mm		in	mm	in	mm	in	mm
GC-OIMB-0606	54515-0606	5/16	7.90	5/8-18			2.80	71		
GC-OIMB-0808	54515-0808	13/32	10.30	3/4-16			2.80	71		
GC-OIMB-1010	54515-1010	1/2	12.70	7/8-14			2.80	71		



O-Ring Insert, Male, Bulkhead, 90 Elbow

Descriptive Number	Product Number	Hose ID		Thread Size	Drop		Length		Valve	
		in	mm		in	mm	in	mm	in	mm
GC-OIMB90-0606	54520-0606	5/16	7.90	5/8-18	2.13	54	1.61	41		
GC-OIMB90-0808	54520-0808	13/32	10.30	3/4-16	2.44	62	1.73	44		
GC-OIMB90-1010	54520-1010	1/2	12.70	7/8-14	2.52	64	2.01	51		

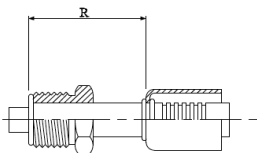

O-Ring Insert, Male, R134a Valve

Picture same as GC-OIM, with 134a Valve

Descriptive Number	Product Number	Hose ID		Thread Size	Drop		Length		Valve	
		in	mm		in	mm	in	mm	in	mm
GC-OIM134V-0606	54530-0606	5/16	7.90	5/8-18			2.44	62	0.63	16
GC-OIM134V-0808	54530-0808	13/32	10.30	3/4-16			2.56	65	0.63	16
GC-OIM134V-1010	54530-1010	1/2	12.70	7/8-14			1.77	45	0.51	13
GC-OIM134V-1212	54530-1212	5/8	15.90	1 1/16-14			2.95	75	0.51	13

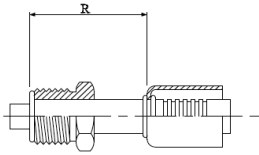

O-Ring Insert, Male, R134a Valve, 90 Elbow

Picture same as GC-OIM90, with R134a Valve

Descriptive Number	Product Number	Hose ID		Thread Size	Drop		Length		Valve	
		in	mm		in	mm	in	mm	in	mm
GC-OIM134V90-0606	54535-0606	5/16	7.90	5/8-18	1.38	35	1.77	45	0.63	16
GC-OIM134V90-0808	54535-0808	13/32	10.30	3/4-16	1.73	44	1.26	32	0.63	16
GC-OIM134V90-1010	54535-1010	1/2	12.70	7/8-14	2.17	55	1.97	50	0.51	13

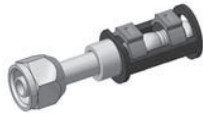

O-Ring Tube, Female, Swivel

Descriptive Number	Product Number	Hose ID		Thread Size	Drop		Length		Valve	
		in	mm		in	mm	in	mm	in	mm
GC-OTF-0605	54600-0605	5/16	7.90	9/16-18			1.06	27		
GC-OTF-0606	54600-0606	5/16	7.90	5/8-18			1.06	27		
GC-OTF-0608	54600-0608	5/16	7.90	3/4-16			1.22	31		
GC-OTF-0806	54600-0806	13/32	10.30	5/8-18			1.22	31		
GC-OTF-0808	54600-0808	13/32	10.30	3/4-16			1.22	31		
GC-OTF-1008	54600-1008	1/2	12.70	3/4-16			1.22	31		
GC-OTF-1010	54600-1010	1/2	12.70	7/8-14			1.61	41		
GC-OTF-1012	54600-1012	1/2	12.70	1 1/16-14			1.73	44		
GC-OTF-1210	54600-1210	5/8	15.90	7/8-14			1.61	41		
GC-OTF-1212	54600-1212	5/8	15.90	1 1/16-14			1.73	44		



O-Ring Tube, Female, Swivel, 45 Elbow

Descriptive Number	Product Number	Hose ID		Thread Size	Drop		Length		Valve	
		in	mm		in	mm	in	mm	in	mm
GC-OTF45-0606	54603-0606	5/16	7.90	5/8-18	0.55	14	0.67	17		
GC-OTF45-0806	54603-0806	13/32	10.30	5/8-18	0.55	14	0.67	17		
GC-OTF45-0808	54603-0808	13/32	10.30	3/4-16	0.59	15	1.77	45		
GC-OTF45-1008	54603-1008	1/2	12.70	3/4-16	0.59	15	1.77	45		
GC-OTF45-1010	54603-1010	1/2	12.70	4/8-14	0.67	17	1.77	45		
GC-OTF45-1210	54603-1210	5/8	15.90	7/8-14	0.67	17	1.77	45		
GC-OTF45-1212	54603-1212	5/8	15.90	1 1/16-14	1.18	30	1.77	45		



O-Ring Tube, Female, Swivel, 90 Elbow

Descriptive Number	Product Number	Hose ID		Thread Size	Drop		Length		Valve	
		in	mm		in	mm	in	mm	in	mm
GC-OTF90-0605	54605-0605	5/16	7.90	9/16-18	1.26	32	1.10	28		
GC-OTF90-0606	54605-0606	5/16	7.90	5/8-18	1.26	32	1.10	28		
GC-OTF90-0608	54605-0608	5/16	7.90	3/4-16	1.42	36	1.42	36		
GC-OTF90-0806	54605-0806	13/32	10.30	5/8-18	1.65	42	1.81	46		
GC-OTF90-0808	54605-0808	13/32	10.30	3/4-16	1.42	36	1.42	36		
GC-OTF90-1008	54605-1008	1/2	12.70	3/4-16	1.42	36	1.42	36		
GC-OTF90-1010	54605-1010	1/2	12.70	7/8-14	1.65	42	1.81	46		
GC-OTF90-1012	54605-1012	1/2	12.70	1 1/16-14	1.77	45	2.05	52		
GC-OTF90-1210	54605-1210	5/8	15.90	7/8-14	1.65	42	1.81	46		
GC-OTF90-1212	54605-1212	5/8	15.90	1 1/16-14	1.77	45	2.05	52		

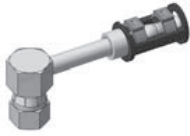

O-Ring Tube, Female, Swivel, 90 Block Elbow

Descriptive Number	Product Number	Hose ID		Thread Size	Drop		Length		Valve	
		in	mm		in	mm	in	mm	in	mm
GC-OTF90B-0808	54610-0808	13/32	10.30	3/4-16	0.91	23	1.97	50		
GC-OTF90B-1010	54610-1010	1/2	12.70	7/8-14	0.94	24	1.97	50		
GC-OTF90B-1212	54610-1212	5/8	15.90	7/8-14	0.94	24	1.97	50		



O-Ring Tube, Female, Swivel, 180 Elbow

Descriptive Number	Product Number	Hose ID		Thread Size	Drop		Length		Valve	
		in	mm		in	mm	in	mm	in	mm
GC-OTF180-0606	54615-0606	5/16	7.90	5/8-16	1.97	50	2.13	54		
GC-OTF180-0808	54615-0808	13/32	10.30	3/4-16	2.36	60	2.13	54		
GC-OTF180-1212	54615-1212	5/8	15.90	1 1/16-14	3.15	80	3.15	80		

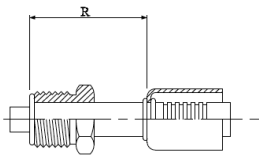

O-Ring Tube, Female, Swivel, R12 Valve

Picture same as GC-OTF, with R12 Valve

Descriptive Number	Product Number	Hose ID		Thread Size	Drop		Length		Valve	
		in	mm		in	mm	in	mm	in	mm
GC-OTF12V-0606	54650-0606	5/16	7.90	5/8-18			1.06	27	1/4	6.35
GC-OTF12V-0808	54650-0808	13/32	10.30	3/4-16			1.22	31	1/4	6.35
GC-OTF12V-1010	54650-1010	1/2	12.70	7/8-14			1.61	41	1/4	6.35

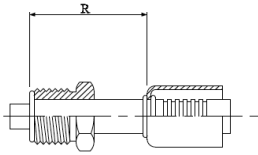

O-Ring Tube, Female, Swivel, R12 Valve, 90 Elbow

Picture same as GC-OTF90, with R12 Valve

Descriptive Number	Product Number	Hose ID		Thread Size	Drop		Length		Valve	
		in	mm		in	mm	in	mm	in	mm
GC-OTF12V90-0606	54655-0606	5/16	7.90	5/8-18	1.26	32	1.10	28	1/4	6.35
GC-OTF12V90-0808	54655-0808	13/32	10.30	3/4-16	1.42	36	1.42	36	1/4	6.35
GC-OTF12V90-1010	54655-1010	1/2	12.70	7/8-14	1.65	42	1.81	46	1/4	6.35
GC-OTF12V90-1210	54655-1210	5/8	15.90	7/8-14	1.50	38	1.50	38	1/4	6.35



O-Ring Tube, Female, Swivel, R134a Valve

Descriptive Number	Product Number	Hose ID		Thread Size	Drop		Length		Valve	
		in	mm		in	mm	in	mm	in	mm
GC-OTF134V-0606	54660-0606	5/16	7.90	5/8-18			1.06	27	0.63	16
GC-OTF134V-0808	54660-0808	13/32	10.30	3/4-16			1.22	31	0.63	16
GC-OTF134V-1010	54660-1010	1/2	12.70	7/8-14			1.61	41	0.51	13
GC-OTF134V-1210	54660-1210	5/8	15.90	7/8-14			1.61	41	0.51	13
GC-OTF134V-1212	54660-1212	5/8	15.90	1 1/16-14			1.73	44	0.51	13
GC-OTF134VHS-1010	54675-1010	5/8	15.90	7/8-14			1.61	41	0.63	16



O-Ring Tube, Female, Swivel, R134a Valve, 45 Elbow

Descriptive Number	Product Number	Hose ID		Thread Size	Drop		Length		Valve	
		in	mm		in	mm	in	mm	in	mm
GC-OTF134V45-0606	54663-0606	5/16	7.90	5/8-18	0.55	14	0.98	25	0.63	16
GC-OTF134V45-0808	54663-0808	13/32	10.30	3/4-16	0.59	15	1.02	26	0.63	16
GC-OTF134V45-1010	54663-1010	1/2	12.70	7/8-14	0.67	17	1.06	27	0.51	13
GC-OTF134V45-1210	54663-1210	5/8	15.90	7/8-14	0.67	17	1.06	27	0.51	13
GC-OTF134V45-1212	54663-1212	5/8	15.90	1 1/16-14	0.94	24	1.77	45	0.51	13



O-Ring Tube, Female, Swivel, R134a Valve, 90 Elbow

Descriptive Number	Product Number	Hose ID		Thread Size	Drop		Length		Valve	
		in	mm		in	mm	in	mm	in	mm
GC-OTF134V90-0606	54665-0606	5/16	7.90	5/8-18	1.26	32	1.10	28	0.63	16
GC-OTF134V90-0806	54665-0806	13/32	10.30	5/8-18	1.26	32	1.10	28	0.63	16
GC-OTF134V90-0808	54665-0808	13/32	10.30	3/4-16	1.42	36	1.42	36	0.63	16
GC-OTF134V90-1010	54665-1010	1/2	12.70	7/8-14	1.65	42	1.81	46	0.51	13
GC-OTF134V90-1210	54665-1210	5/8	15.90	7/8-14	1.65	42	1.81	46	0.51	13
GC-OTF134V90-1212	54665-1212	5/8	15.90	1 1/16-14	1.77	45	2.05	52	0.51	13



O-Ring Tube, Male, Swivel

Descriptive Number	Product Number	Hose ID		Thread Size	Drop		Length		Valve	
		in	mm		in	mm	in	mm	in	mm
GC-OTM-0606	54700-0606	5/16	7.90	5/8-18			1.14	29		
GC-OTM-0607	54700-0607	5/16	7.90	11/16-16			1.14	29		
GC-OTM-0608	54700-0608	5/16	7.90	3/4-18			1.18	30		
GC-OTM-0806	54700-0806	13/32	10.30	5/8-18			1.18	30		
GC-OTM-0808	54700-0808	13/32	10.30	3/4-18			1.73	44		
GC-OTM-1010	54700-1010	1/2	12.70	7/8-18			1.81	46		
GC-OTM-1012	54700-1012	1/2	12.70	1 1/16-14			1.81	46		
GC-OTM-1210	54700-1210	5/8	15.90	7/8-18			1.81	46		
GC-OTM-1212	54700-1212	5/8	15.90	1 1/16-14			2.05	52		



O-Ring Tube, Male, Swivel, 45 Elbow

Descriptive Number	Product Number	Hose ID		Thread Size	Drop		Length		Valve	
		in	mm		in	mm	in	mm	in	mm
GC-OTM45-0606	54703-0606	5/16	7.90	5/8-18	0.87	22	0.79	20		
GC-OTM45-0608	54703-0608	5/16	7.90	3/4-18	0.87	22	0.79	20		
GC-OTM45-0806	54703-0806	13/32	10.30	5/8-18	0.87	22	0.79	20		
GC-OTM45-0808	54703-0808	13/32	10.30	3/4-18	0.98	25	1.06	27		
GC-OTM45-1010	54703-1010	1/2	12.70	7/8-18	1.06	27	1.30	33		
GC-OTM45-1210	54703-1210	5/8	15.90	7/8-18	1.18	30	1.46	37		
GC-OTM45-1212	54703-1212	5/8	15.90	1 1/16-14	1.18	30	1.46	37		



O-Ring Tube, Male, Swivel, 90 Elbow

Descriptive Number	Product Number	Hose ID		Thread Size	Drop		Length		Valve	
		in	mm		in	mm	in	mm	in	mm
GC-OTM90-0606	54705-0606	5/16	7.90	5/8-18	1.46	37	1.02	26		
GC-OTM90-0608	54705-0608	5/16	7.90	3/4-18	1.46	37	1.02	26		
GC-OTM90-0806	54705-0806	13/32	10.30	5/8-18	1.46	37	1.02	26		
GC-OTM90-0808	54705-0808	13/32	10.30	3/4-18	1.77	45	1.34	34		
GC-OTM90-1010	54705-1010	1/2	12.70	7/8-18	2.05	52	1.65	42		
GC-OTM90-1012	54705-1012	1/2	12.70	1 1/16-14	2.05	52	1.65	42		
GC-OTM90-1210	54705-1210	5/8	15.90	7/8-18	2.05	52	1.65	42		
GC-OTM90-1212	54705-1212	5/8	15.90	1 1/16-14	2.36	60	1.89	48		



O-Ring Tube, Male, Swivel, Long Pilot

Descriptive Number	Product Number	Hose ID		Thread Size	Drop		Length		Valve	
		in	mm		in	mm	in	mm	in	mm
GC-OTMLP-0606	54720-0606	5/16	7.90	5/8-18			1.14	29		
GC-OTMLP-0808	54720-0808	13/32	10.30	3/4-18			1.73	44		
GC-OTMLP-1010	54720-1010	1/2	12.70	7/8-18			1.81	46		
GC-OTMLP-1212	54720-1212	5/8	15.90	7/8-18			1.81	46		



O-Ring Tube, Male, Swivel, R134a Valve

Picture same as GO-OTM, with 134a Valve

Descriptive Number	Product Number	Hose ID		Thread Size	Drop		Length		Valve	
		in	mm		in	mm	in	mm	in	mm
GC-OTM134V-0606	54730-0606	5/16	7.90	5/8-18			1.06	27	0.63	16
GC-OTM134V-0808	54730-0808	13/32	10.30	3/4-18			1.22	31	0.63	16
GC-OTM134V-1010	54730-1010	1/2	12.70	7/8-18			1.61	41	0.51	13
GC-OTM134V-1210	54730-1210	5/8	15.90	7/8-18			1.73	44	0.51	13
GC-OTM134V-1212	54730-1212	5/8	15.90	1 1/16-14			1.73	44	0.51	13



O-Ring Tube, Male, Swivel, R134a Valve, 90 Elbow

Descriptive Number	Product Number	Hose ID		Thread Size	Drop		Length		Valve	
		in	mm		in	mm	in	mm	in	mm
GC-OTM134V90-1010	54735-1010	1/2	12.70	7/8-18	2.05	52	1.65	42	0.51	13
GC-OTM134V90-1210	54735-1210	5/8	15.90	7/8-18	2.05	52	1.65	42	0.51	13



SAE 45 Flare, Female, Swivel

Descriptive Number	Product Number	Hose ID		Thread Size	Drop		Length		Valve	
		in	mm		in	mm	in	mm	in	mm
GC-SFFX-0606	54760-0606	5/16	7.90	5/8-18			1.38	35		
GC-SFFX-0608	54760-0608	5/16	7.90	3/4-16			1.38	35		
GC-SFFX-0806	54760-0806	13/32	10.30	5/8-18			1.77	45		
GC-SFFX-0808	54760-0808	13/32	10.30	3/4-16			1.77	45		
GC-SFFX-1008	54760-1008	1/2	12.70	3/4-16			1.77	45		
GC-SFFX-1010	54760-1010	1/2	12.70	7/8-14			1.97	50		
GC-SFFX-1210	54760-1210	5/8	15.90	7/8-14			1.97	50		
GC-SFFX-1212	54760-1212	5/8	15.90	1 1/16-14			2.17	55		



SAE 45 Flare, Female, Swivel, 45 Elbow

Descriptive Number	Product Number	Hose ID		Thread Size	Drop		Length		Valve	
		in	mm		in	mm	in	mm	in	mm
GC-SFFX45-0606	54763-0606	5/16	7.90	5/8-18	0.79	20	2.17	55		
GC-SFFX45-0608	54763-0608	5/16	7.90	3/4-16	0.79	20	2.17	55		
GC-SFFX45-0806	54763-0806	13/32	10.30	5/8-18	0.79	20	2.17	55		
GC-SFFX45-0808	54763-0808	13/32	10.30	3/4-16	0.79	20	2.36	60		
GC-SFFX45-1008	54763-1008	1/2	12.70	3/4-16	0.79	20	2.36	60		
GC-SFFX45-1010	54763-1010	1/2	12.70	7/8-14	0.87	22	2.36	60		
GC-SFFX45-1210	54763-1210	5/8	15.90	7/8-14	0.87	22	2.36	60		
GC-SFFX45-1212	54763-1212	5/8	15.90	1 1/16-14	0.87	22	2.36	60		



SAE 45 Flare, Female, Swivel, 90 Elbow

Descriptive Number	Product Number	Hose ID		Thread Size	Drop		Length		Valve	
		in	mm		in	mm	in	mm	in	mm
GC-SFFX90-0606	54765-0606	5/16	7.90	5/8-18	1.18	30	1.38	35		
GC-SFFX90-0608	54765-0608	5/16	7.90	3/4-16	1.18	30	1.38	35		
GC-SFFX90-0806	54765-0806	13/32	10.30	5/8-18	1.18	30	1.38	35		
GC-SFFX90-0808	54765-0808	13/32	10.30	3/4-16	1.77	45	1.38	35		
GC-SFFX90-1008	54765-1008	1/2	12.70	3/4-16	1.77	45	1.38	35		
GC-SFFX90-1010	54765-1010	1/2	12.70	7/8-14	1.77	45	1.77	45		
GC-SFFX90-1210	54765-1210	5/8	15.90	7/8-14	1.77	45	1.77	45		
GC-SFFX90-1212	54765-1212	5/8	15.90	1 1/16-14	1.77	45	1.77	45		



SAE 45 Flare, Male

Descriptive Number	Product Number	Hose ID		Thread Size	Drop		Length		Valve	
		in	mm		in	mm	in	mm	in	mm
GC-SFM-0606A	54780-0606A	5/16	7.90	5/8-18			1.38	35		
GC-SFM-0808A	54780-0808A	13/32	10.30	3/4-16			1.38	35		
GC-SFM-1010A	54780-1010A	1/2	12.70	7/8-14			1.50	38		
GC-SFM-1212A	54780-1212A	5/8	15.90	1 1/16-14			1.73	44		



SAE 45 Flare, Male, 45 Elbow

Descriptive Number	Product Number	Hose ID		Thread Size	Drop		Length		Valve	
		in	mm		in	mm	in	mm	in	mm
GC-SFM45-0606A	54783-0606A	5/16	7.90	5/8-18	0.75	19	1.38	35		
GC-SFM45-0808A	54783-0808A	13/32	10.30	3/4-16	0.94	24	1.38	35		
GC-SFM45-1010A	54783-1010A	1/2	12.70	7/8-14	1.26	32	1.77	45		
GC-SFM45-1212A	54783-1212A	5/8	15.90	1 1/16-14	1.38	35	1.77	45		



SAE 45 Flare, Male, 90 Elbow

Descriptive Number	Product Number	Hose ID		Thread Size	Drop		Length		Valve	
		in	mm		in	mm	in	mm	in	mm
GC-SFM90-0606A	54785-0606A	5/16	7.90	5/8-18	1.18	30	1.38	35		
GC-SFM90-0808A	54785-0808A	13/32	10.30	3/4-16	1.77	45	1.38	35		
GC-SFM90-1010A	54785-1010A	1/2	12.70	7/8-14	1.77	45	1.77	45		
GC-SFM90-1212A	54785-1212A	5/8	15.90	1 1/16-14	1.77	45	1.77	45		

AC Adapters

For use with Galaxy® G4826 (5/16"-5/8") and G4867 (3/4") Hose

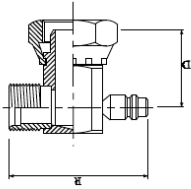

O-Ring Tube Compressor to O-Ring Insert, Male, 90 Elbow, R134a Valve

Descriptive Number	Product Number	Thread Size OTF	Thread Size OIM
AC-OTCF10-OIM08-90-134V	50900-1008	1-14	3/4-16
AC-OTCF10-OIM10-90-134V	50900-1010	1-14	7/8-14



O-Ring Tube, Female to O-Ring Insert Male, R12 Valve

Picture same as AC-OTF-OIM-134V, with R12 Valve

Descriptive Number	Product Number	Thread Size OTF	Thread Size OIM
AC-OTF06-OIM06-12V	50910-0606	5/8-18	5/8-18
AC-OTF08-OIM08-12V	50910-0808	3/4-16	3/4-16
AC-OTF10-OIM10-12V	50910-1010	7/8-14	7/8-14
AC-OTF12-OIM12-12V	50910-1212	1 1/16-14	1 1/16-14



O-Ring Tube, Female to O-Ring Insert, Male, 90 Elbow, R12 Valve

Descriptive Number	Product Number	Thread Size OTF	Thread Size OIM
AC-OTF06-OIM06-90-12V	50915-0606	5/8-18	5/8-18
AC-OTF08-OIM08-90-12V	50915-0808	3/4-16	3/4-16
AC-OTF10-OIM10-90-12V	50915-1010	7/8-14	7/8-14
AC-OTF12-OIM12-90-12V	50915-1212	1 1/16-14	1 1/16-14

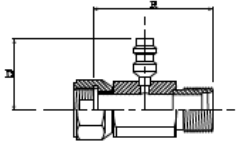

O-Ring Tube, Female to O-Ring Insert, Male, R134a Valve

Descriptive Number	Product Number	Thread Size OTF	Thread Size OIM
AC-OTF06-OIM06-134V	50920-0606	5/8-18	5/8-18
AC-OTF08-OIM08-134V	50920-0808	3/4-16	3/4-16
AC-OTF10-OIM10-134V	50920-1010	7/8-14	7/8-14
AC-OTF12-OIM12-134V	50920-1212	1 1/16-14	1 1/16-14



O-Ring Tube, Female to O-Ring Insert, Male, 90 Elbow, R134a Valve

Descriptive Number	Product Number	Thread Size OTF	Thread Size OIM
AC-OTF06-OIM06-90-134V	50925-0606	5/8-18	5/8-18
AC-OTF08-OIM08-90-134V	50925-0808	3/4-16	3/4-16
AC-OTF10-OIM10-90-134V	50925-1010	7/8-14	7/8-14
AC-OTF12-OIM12-90-134V	50925-1212	1 1/16-14	1 1/16-14

AC Clip Fitting Accessories



Flareless Tube Nuts

Descriptive Number	Product Number	Thread Size	Tube OD (in.)
AC-FTN-0006	50250-0006	5/8-18	3/8
AC-FTN-0008	50250-0008	3/4-16	1/2
AC-FTN-0010	50250-0010	7/8-14	5/8
AC-FTN-0012	50250-0012	1 1/16-14	3/4



Flareless Tube Sleeves

Descriptive Number	Product Number	Thread Size	Tube OD (in.)
AC-FTS-0006	50255-0006		3/8
AC-FTS-0008	50255-0008		1/2
AC-FTS-0010	50255-0010		5/8
AC-FTS-0012	50255-0012		3/4



Flareless Tube Sleeves, Metric

Descriptive Number	Product Number	Thread Size	Tube OD (mm.)
AC-FTSM-0008	50260-0008		8
AC-FTSM-0012	50260-0012		12
AC-FTSM-0015	50260-0015		14.5



Inline Orifice Tubes

Descriptive Number	Product Number	Orifice Tube OD		Orifice Tube Length		Description
		in	mm	in	mm	
AC-ILOTORA-0057	50401-0057	0.057	1.4	3.50	88.9	Inline Orifice Tube, Ford, Orange
AC-ILOTRED-0062	50401-0062	0.062	1.6	3.50	88.9	Inline Orifice Tube, Ford, Red
AC-ILOTBLU-0072	50401-0072	0.072	1.8	3.50	88.9	Inline Orifice Tube, Ford, Blue
AC-ILOTBLK-0072	50401-0072	0.072	1.8	3.50	88.9	Inline Orifice Tube, GM, Black
AC-ILOTWHI-0072	50401-0072	0.072	1.8	3.50	88.9	Inline Orifice Tube, GM, White



O-Ring for Ford Spring Lock

Descriptive Number	Product Number	Orifice Tube OD	
		in	mm
GC-OFSL-0006	54450-0006	3/8	9.5
GC-OFSL-0008	54450-0008	1/2	12.7
GC-OFSL-0010	54450-0010	5/8	15.9
GC-OFSL-0012	54450-0012	3/4	19.1



O-Ring for Switch

Descriptive Number	Product Number	Orifice Tube OD	
		in	mm
GC-OSWCH-0006	54455-0006	3/8	9.5

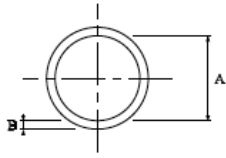

O-Ring for Tube Fittings

Descriptive Number	Product Number	O-Ring ID		O-Ring Thickness	
		in	mm	in	mm
AC-OTUBE-0006	50460-0006	0.30	7.6	0.07	1.8
AC-OTUBE-0008	50460-0008	0.43	10.9	0.07	1.8
AC-OTUBE-0010	50460-0010	0.55	14	0.07	1.8
AC-OTUBE-0012	50460-0012	0.68	17.3	0.07	1.8



Sealing Washers

Descriptive Number	Product Number	ID	Product Description
		in	
AC-SWA-0012	50800-0012	3/4	Sealing Washer, Accumulator
AC-SWCN-0010	50803-0010	5/8	Sealing Washer, Compressor, Narrow
AC-SWCN-0012	50803-0012	3/4	Sealing Washer, Compressor, Narrow
AC-SWCW-0010	50805-0010	5/8	Sealing Washer, Compressor, Wide



Valve Adapters

Descriptive Number	Product Number	R12 Thread Size	R134a	Product Description
			mm	
AC-VA12V3/16-134V16	50820-0001	3/8-24	16	Converts R12 to R134a Valve
AC-VA12V1/4-134V13	50820-0002	7/16-20	13	Converts R12 to R134a Valve
AC-VA12V1/4-134V16	50820-0003	7/16-20	16	Converts R12 to R134a Valve

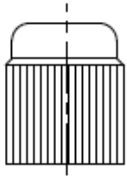

Valve Caps

Descriptive Number	Product Number	Valve Style	Valve Size
AC-VC12V-0001	50830-0001	R12	1/4 in.
AC-VC134VHS-0002	50830-0002	R134a H.S.	16 mm.
AC-VC134VLS-0003	50830-0003	R134a L.S.	13 mm.



Valve Core

Descriptive Number	Product Number	Thread Size
AC-VCORE-0001	50835-0001	0.210x36



Metal Clip

Descriptive Number	Product Number	Hose ID	
		in	mm
GC-CLIP-0006	54850-0006	5/16	7.9
GC-CLIP-0008	54850-0008	13/32	10.3
GC-CLIP-0010	54850-0010	1/2	12.7
GC-CLIP-0012	54850-0012	5/8	15.9

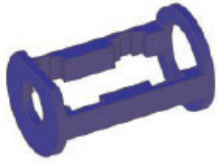

Plastic Clip Holder

Descriptive Number	Product Number	Hose ID	
		in	mm
GC-CLIPHLDR-0006	54855-0006	5/16	7.9
GC-CLIPHLDR-0008	54855-0008	13/32	10.3
GC-CLIPHLDR-0010	54855-0010	1/2	12.7
GC-CLIPHLDR-0012	54855-0012	5/8	15.9



Clip Pliers

Descriptive Number	Product Number	Product Description
GC-PLIERS-0001	54860-0001	Clip Pliers for assembly of Cool Clip Fittings



Hose Cutting Tool & Replacement Blades

Descriptive Number	Product Number	Product Description
65090 HCT	65090	Hose Cutting Tool for G4890 Hose
65091 HCTRB	65091	Hose Cutting Tool Replacement Blades - 2/Pkg

Appendix

Cool Clip® AC Hose Assembly Instructions

AC Fitting Crimping Procedures

Cool Clip® AC Hose Assembly Instructions

Special care should be taken when selecting the proper refrigerant hose and fittings. Continental Cool Clip® fittings should only be used with Continental Galaxy® 4890 hose.

Special care must be taken when working with refrigerant systems. Sudden escape of refrigerant gases may result in blindness or severe injury. Continental recommends adherence to guidelines and general practices as defined in SAE J2211 for the service containment of HFC-134a as well as all applicable EPA guidelines and procedures concerning the service of refrigerant systems.

1. Cut the hose to proper length with the Continental hose cutter (Part # 65090).



The cut must be made squarely to the hose length.

2. Install two proper-sized clips into the clipholder. For ease of assembly, both clips should have the same orientation.



3. Place the clipholder with the two clips on the hose. Install the clipholder so that the end with the smallest hole touches the end of the hose.
4. Lubricate the fitting with a generous amount of the AC system's lubricator oil. This is to lower the force of the insertion.



5. Insert the fitting into the hose. Ensure that the fitting is fully inserted so that there is no gap between the end of the hose, the clip retainer and the shoulder of the fitting.

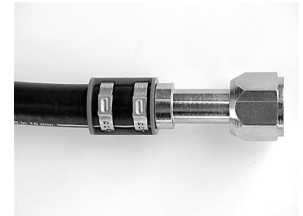

6. Close both clips with the Continental clip pliers, PN GC-Pliers-0001. The pliers will automatically release when the clips have been completely closed. Start with the clip closer to the end of the hose.

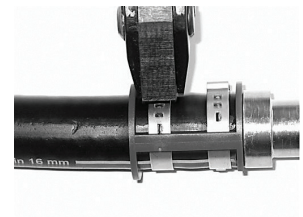

7. Now you have realized a durable hose/fitting connection.

Warning – Selection of Fittings

Selection of the proper Continental hose and fittings for the application is essential to the proper operation and safe use of the hose and related equipment. Inadequate attention to the selection of the hose and fitting for the application can result in hose leakage, bursting or other failures which can cause serious bodily injury or property damage from spraying fluids or flying projectiles. Some of the factors involved in the selection of the proper hose and fittings are:

Hose

- › Size
- › Refrigerant
- › Pressure
- › Length
- › Bends
- › Original Equipment

Fittings

- › Compatibility
- › Pressure
- › Temperature
- › Hose Design
- › Installation Design
- › Corrosion Requirements

If there are any questions as to what fitting should be used, Continental recommends that you consult a local Sales Representative or Continental Hydraulics Application Group for assistance.

AC Fitting Crimping Procedures

PC125 Crimper

1. Insert the pressure plate into the bottom flange of the crimper, making sure that it is seated completely into the bottom flange.

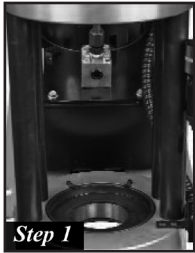

2. Select the correct die set for the Galaxy® hose dash size/ID and "AC" fitting being crimped. Insert the two halves of the die set onto the pressure plate, making

Galaxy® Hose #	ID (in.)	PC125 Die Set
G4826-06	5/16	PC125-AC06
G4826-08	13/32	PC125-AC08
G4826-10	1/2	PC125-AC12
G4826-12	5/8	PC125-AC12
G4826-14	3/4	PC125-AC12

sure both halves are flat and level.

BE SURE TO lubricate the contact surfaces, both bottom and outside edges of the die fingers, the inside of the compression ring and the pressure plate with the die lubricant provided with the crimper. Only use a molybdenum/graphite high-pressure grease applied sparingly to the contact surfaces. Die lubricant can be obtained from Continental using part numbers

Failure to lubricate the contact surfaces with the correct lubricant will cause the dies to seize in the compression ring, causing damage to the dial set as well as possibly damaging the crimper.

PC900-Grease (3 oz.) or PC900-Grease (1 lb.) An aerosol lubricant, PC900-AerosolLube, can also be used.

3. Place the compression ring loosely but evenly over the die set. Make sure the die set is correctly aligned.



4. Slide the pusher in place.
5. Set the micrometer to the setting as shown in the Continental Crimp Specification Manual for the combination of hose and fitting being crimped. The metric micrometer (readings of 0 to 10) is a direct-reading micrometer. The setting on the micrometer is added to the number in millimeters etched on the die ring to obtain the final crimp diameter. The adjuster, set at "0," is the setting for the die set fully closed. For example, with a 34 mm die and the micrometer set at 3.0 mm, the finished crimp diameter would be 37.0 mm (34 mm + 3.0 mm).
6. Attach the coupling stop, included with your crimper, to the base of the crimper.



Select the appropriate Galaxy® hose size and cut to the correct length using Continental Hose Cutting Tool (part #65090). Be sure the hose is cut squarely at a 90° angle to the hose.

7. Insert the hose end fully into the ferrule of the corresponding fitting. When completely inserted, the hose should be visible through the witness hole on the side of the ferrule.



AC Fitting Crimping Procedures

PC125 Crimper

- Insert the hose and fitting through the crimp dies. Align the foot on the coupling stop so that the foot rests on the top of the crimp die and also against the end of the fitting ferrule. Be sure the foot on the coupling stop is against the end of the ferrule and not resting on the bump of the tube above the ferrule.
- Manually depress the compression ring, closing the die set until the hose and fitting are held loosely in the die set. Seat the compression ring evenly on the die set.



Each die set has a limited range of diameters for which a satisfactory crimp can be obtained.

Always consult the Continental Crimp Specification Manual for selecting the correct die set.

CAUTION: The notches on the die set must be completely covered by the compression ring prior to starting the crimp. If the notches are showing, you must go to a larger die set. Crimping with an incorrect die size could result in personal injury.



- Recheck the fitting for the correct alignment in the die set and depress the start/stop switch. Hold the start/stop switch until the automatic stop switch shuts the pump off. Release the start/stop switch and allow the pusher to return to the retracted position.



- Check the crimp diameter of the finished assembly with a caliper or micrometer to be certain that it is within the specifications as outlined in the Continental Crimp Specification Manual. The caliper measurement should be taken in the crimp groove between the ridges as shown.



To properly measure the crimp diameter on “AC” style fittings, your caliper should be a style having notched blades (pictured above).

- Check the completed assembly to be sure that the hose is still visible through the witness hole on the fitting. Also, the crimp grooves should be centered on the fitting ferrule.



If the crimp grooves are too near the fitting end of the ferrule, or too near the hose end of the ferrule, the fitting may not seal properly and the assembly could leak. If your finished crimp assembly resembles either of the two examples shown below, the end of the ferrule was not properly positioned against the coupling stop foot, or the coupling stop foot was not resting on the top of the die set when crimped. A new assembly should be crimped, being sure to follow the procedures in Step 9.

Incorrect Crimp Examples

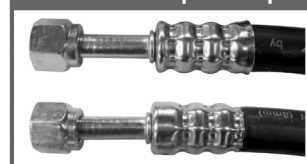

Industrial Fluid Solutions

Market segment

Hydraulic Hose

Contact

Continental

703 S. Cleveland Massillon Road

Fairlawn, OH 44333-3023 U.S.A.

1-800-235-4632

www.contitech.us

Your local contact

www.contitech.de/contactlocator

Canada

1-888-275-4397

Mexico

1-800-439-7373